

# 35313/35314

# scale 1/35

## 產品編號: 35313/35314

## 1:35 比例

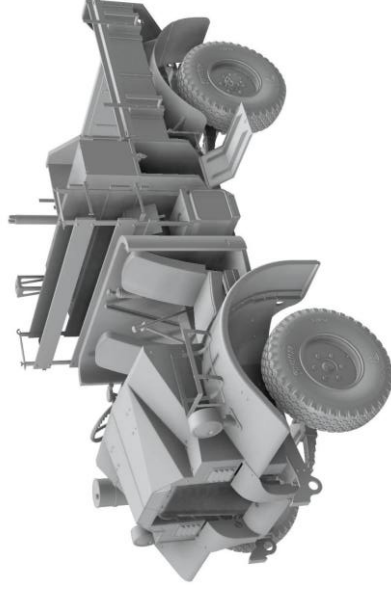

### 1/35 LRDG F8 Pilot Car

Go through this assembly guide and understand it before you start kit assembly  
Use usual plastic kit's cements and tools (not included in the kit)  
Follow painting guide supplied, use only hobby paints  
Work carefully with photo etched parts if included, use C/A glues to assemble them

請您在組裝此產品前仔細閱讀組裝指南；  
請使用通用塑膠模型黏合劑和工具(本產品不附帶)；  
本產品所以提供的噴塗指南只適用於本於模型；  
如果本產品含有蝕刻套件,請小心仔細處理, 請使用C/A膠水組裝；

組み立て前にこの組み立てガイドをご覧ください。  
プラスチックキット専用接着剤と専用工具をご使用ください。(ともにキットには含まれていません)  
塗装ガイドに従ってください。専用塗料をご使用ください。  
エッチングパーツの組み立ては細かいパーツのため注意が必要です。また接着には瞬間接着剤を使用してください。



cut/remove

切下 / 移除

切断/切り離し

drill hole

鑽孔

ドリル穴

no glue

不適用膠水

接着しない

bend

折彎

折り曲げ

cyanoacrylate glue

氰基丙烯酸酯膠水

瞬間接着剤

string or wire

細繩或者金屬絲線

糸または金属線

rope

繩

ひも

PE - press rivets (lines)

蝕刻片 -

from the etched off side

請从蚀刻掉的一侧压铆钉 (线)

ラインやリベット部分を未エッチング面から圧を与える

	S10 SABI	G1	Y1 D'ARTAGNE N	T1 TE RANGI III	R1 ROTOMA/ ROTOMA II
Sand Mat rack on front wing	No	Not Known	No	Yes	Not known
Aerial base	No	Not Known, but most likely fitted early on and then removed	No	Early version yes, later removed	Yes. Most likely removed later
Vickers MKI on Pedestal	Yes	Not Known, but most likely fitted later on	Yes	Late addition	Unknown. Most likely fitted later
Vickers K gun on pedestal for front passenger Aero screens	No	Not Known	No	Late modification	Unknown
	No	Unknown	No	Driver only	No

	<b>Detail Colours</b>
1	Blue Gey
2	Matt Black
3	Flat Aluminium
4	Rust
5	Light Stone
6	Red Brown
7	Chrome Silver
8	Rubber
9	Khaki
10	Flat Brass

**1**

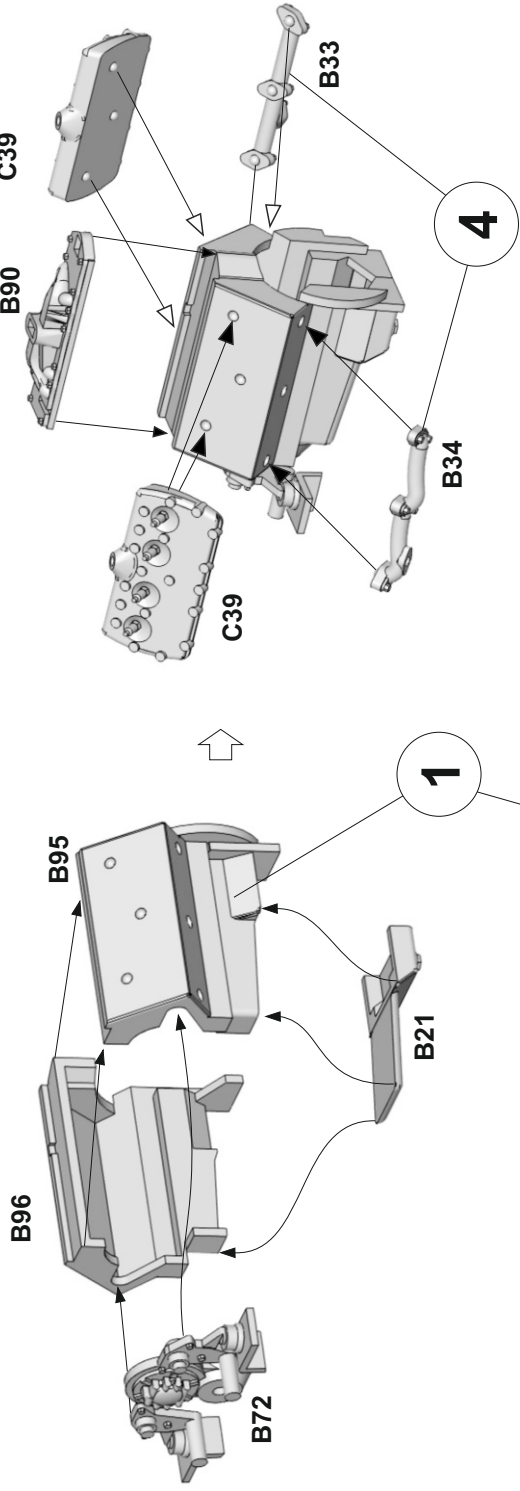

**1**

fill

B31

B70

B69

B73

fill

B84

**3**

**2**

B20

B79

B87

B88

**5**

**3**

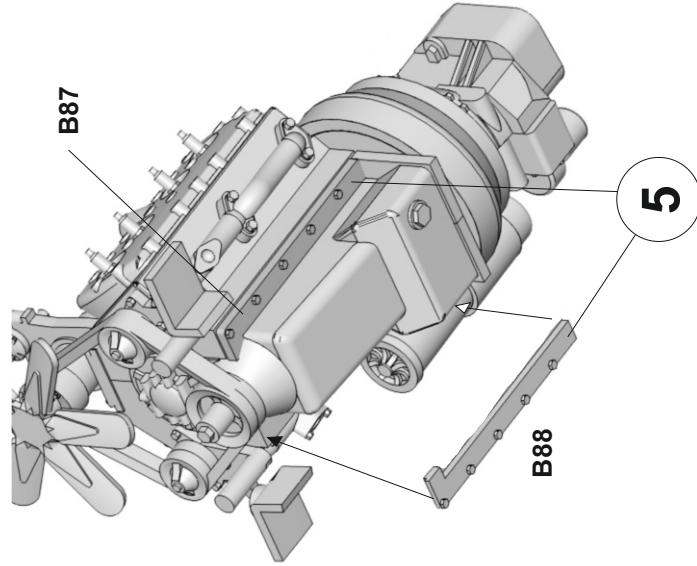

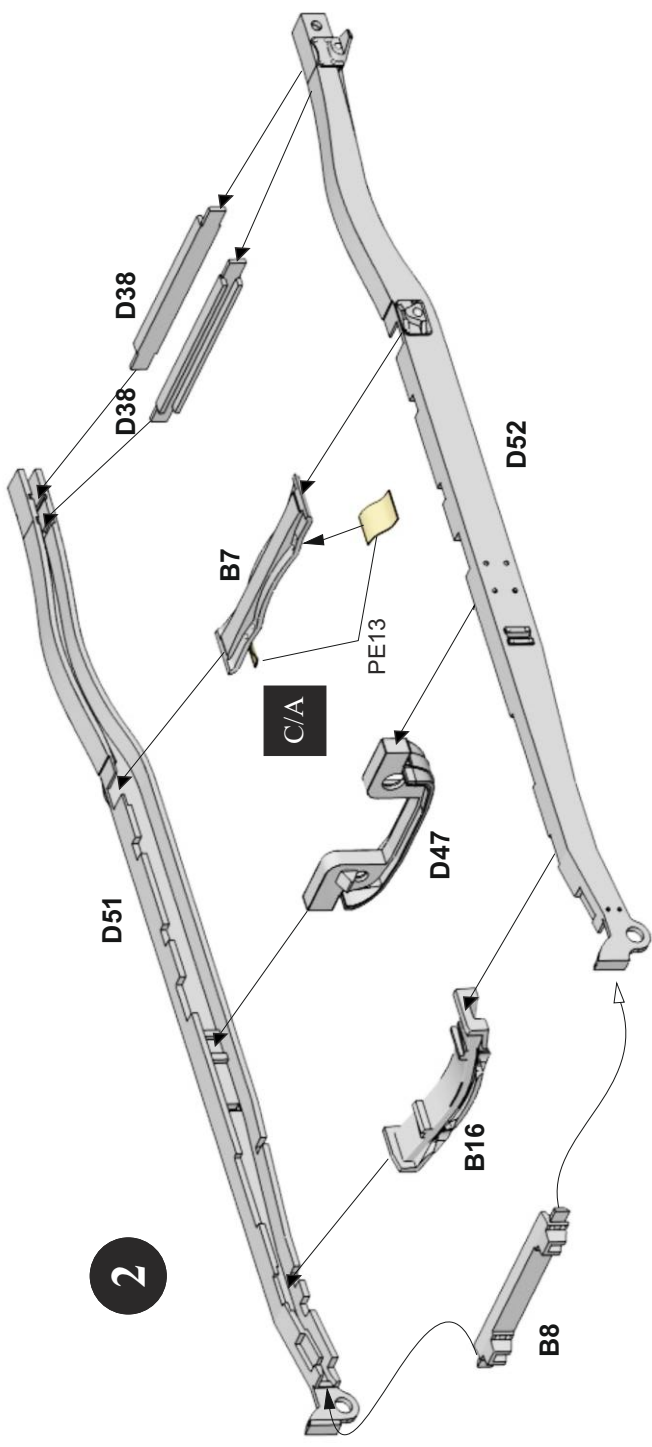

1

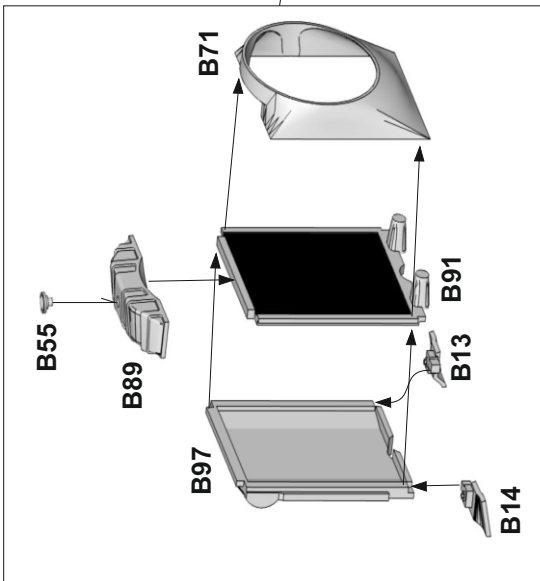
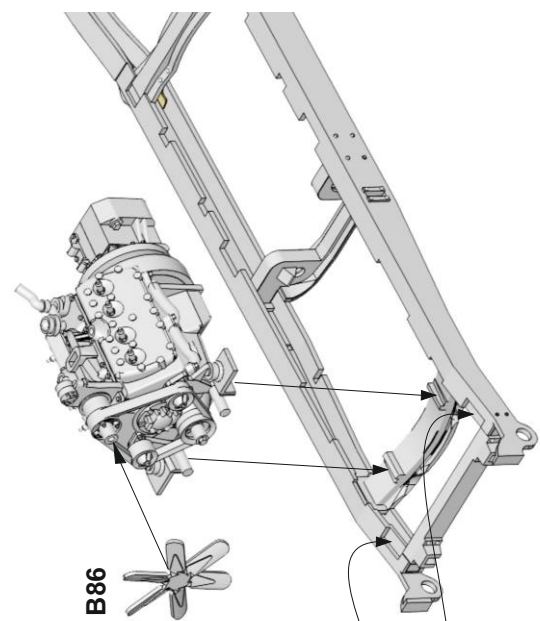

2

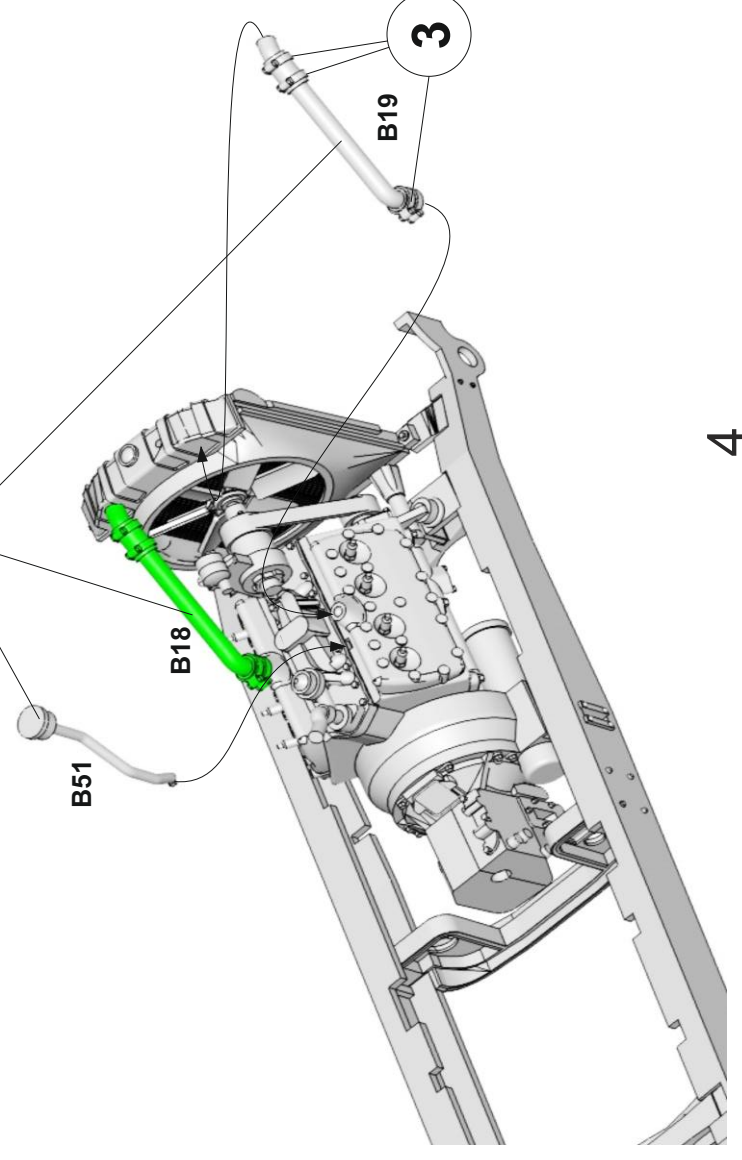

4

3

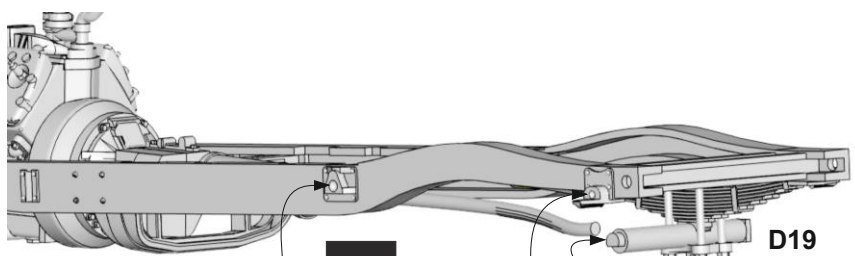
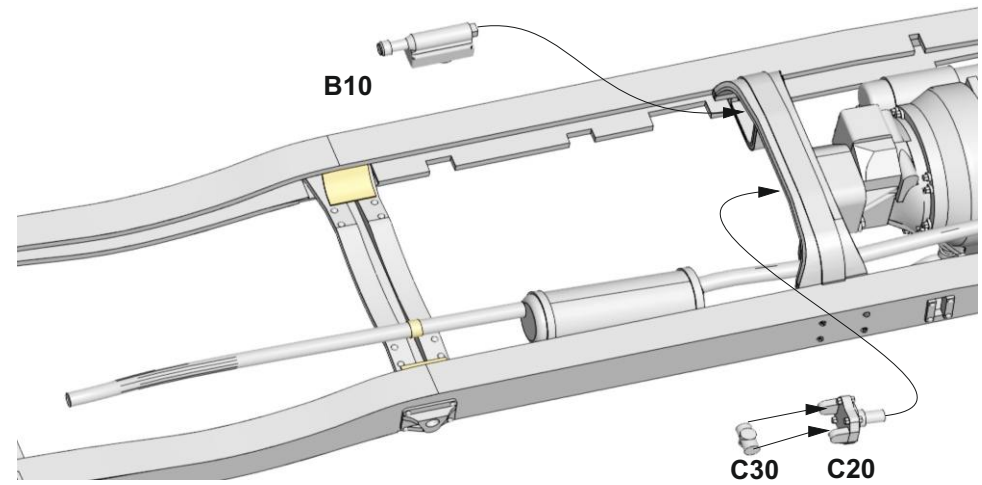
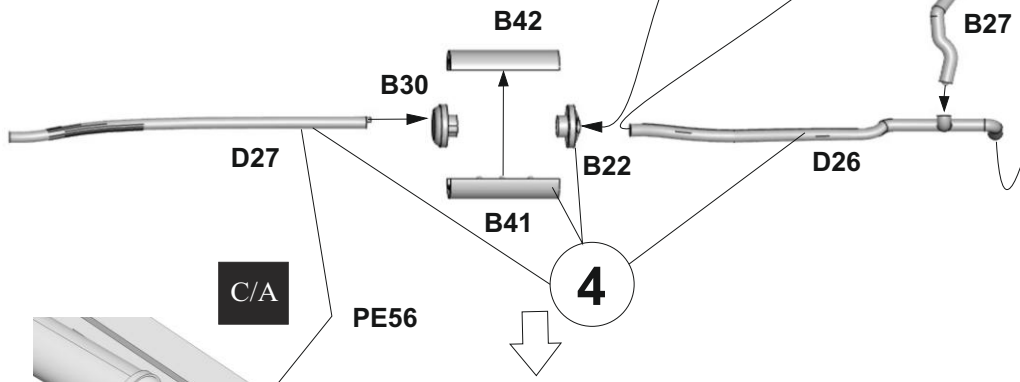
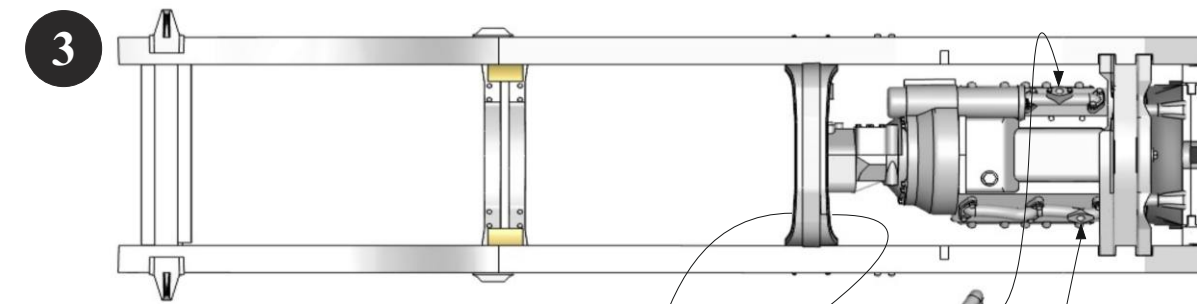

4

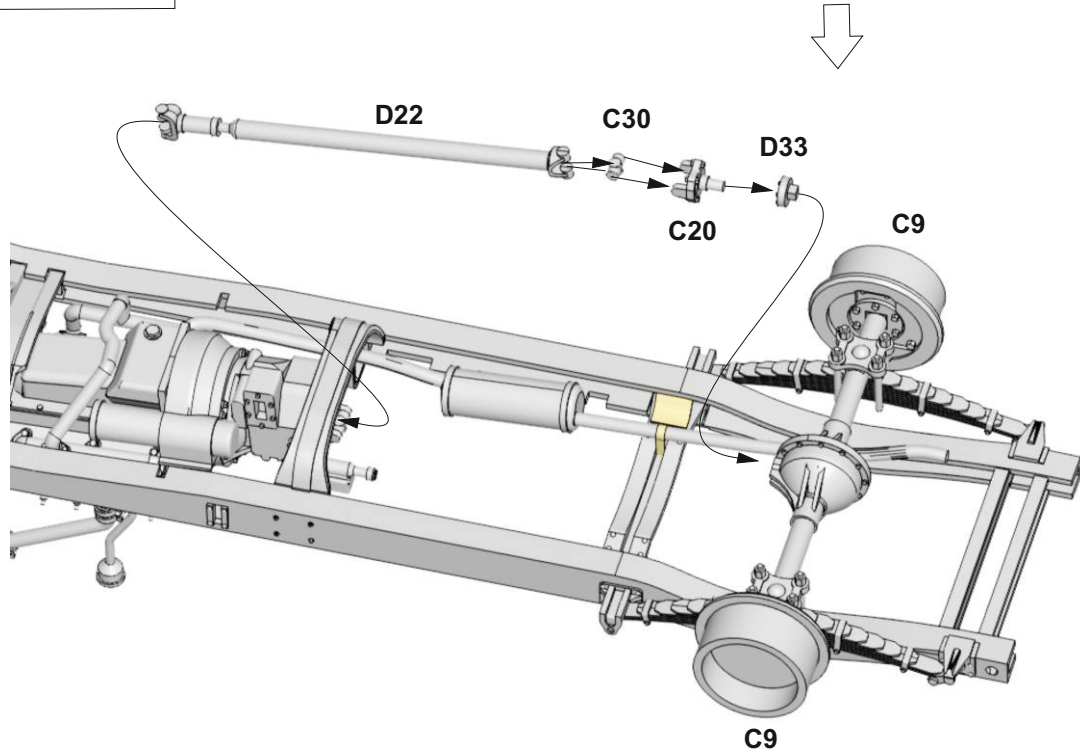
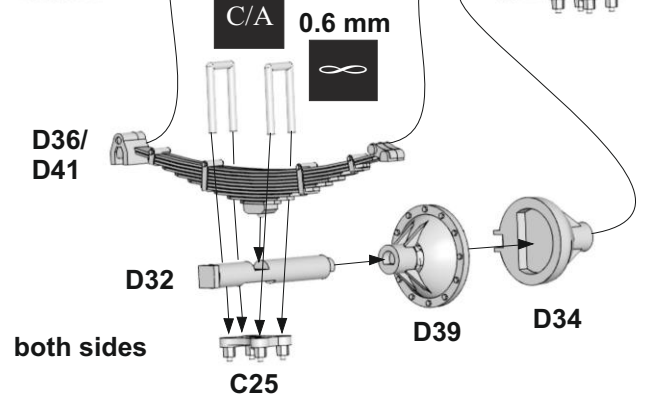

5

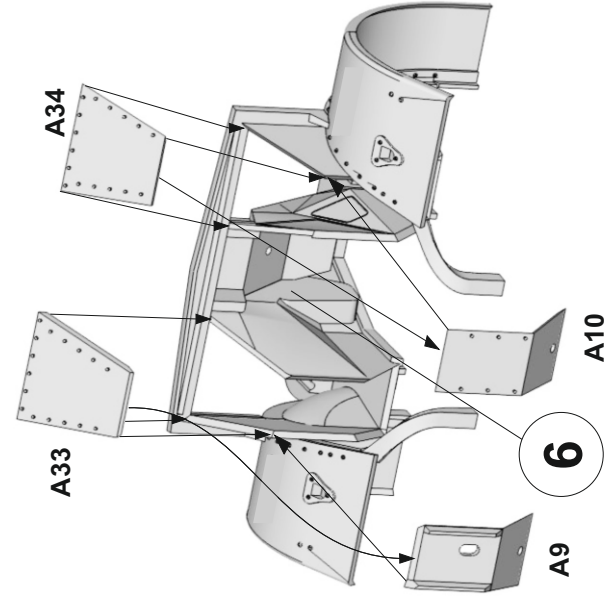
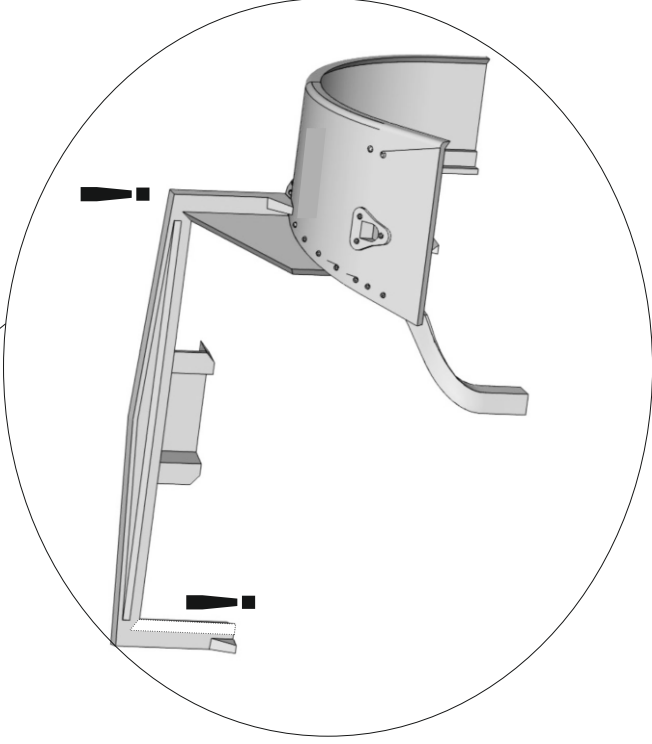
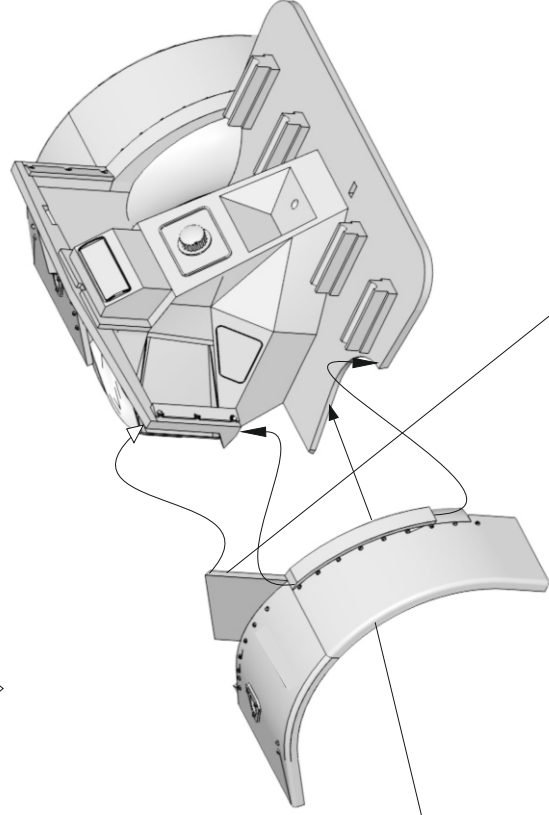
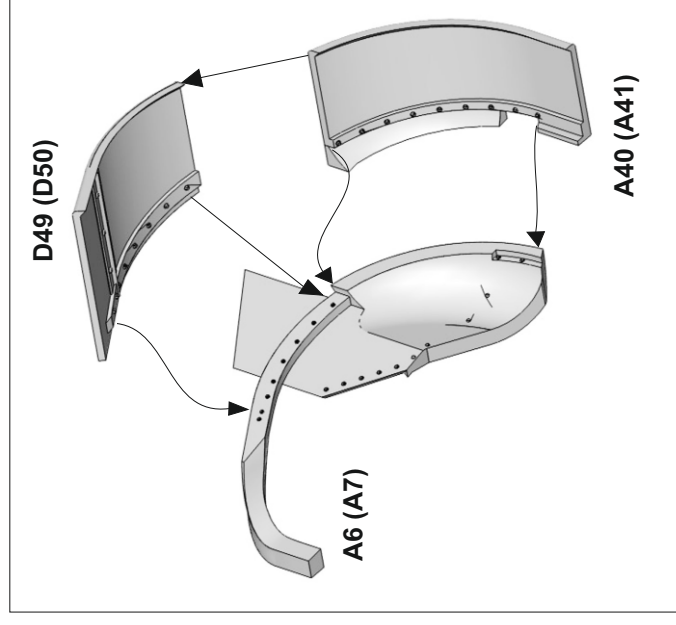
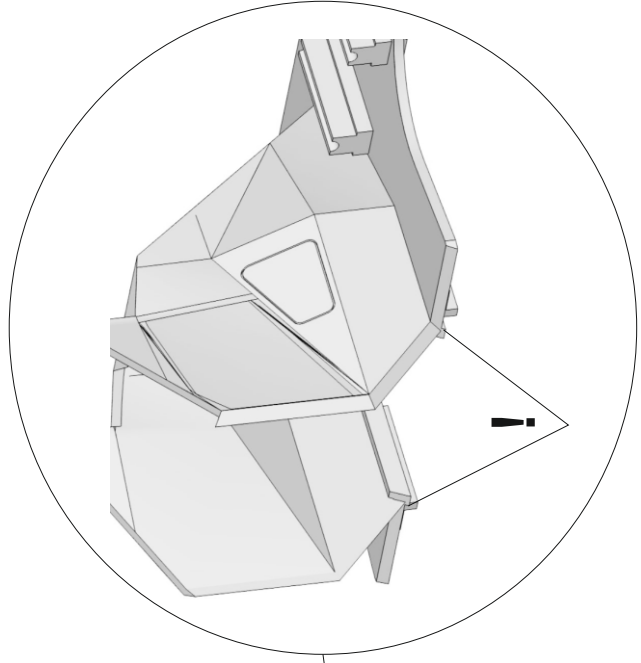
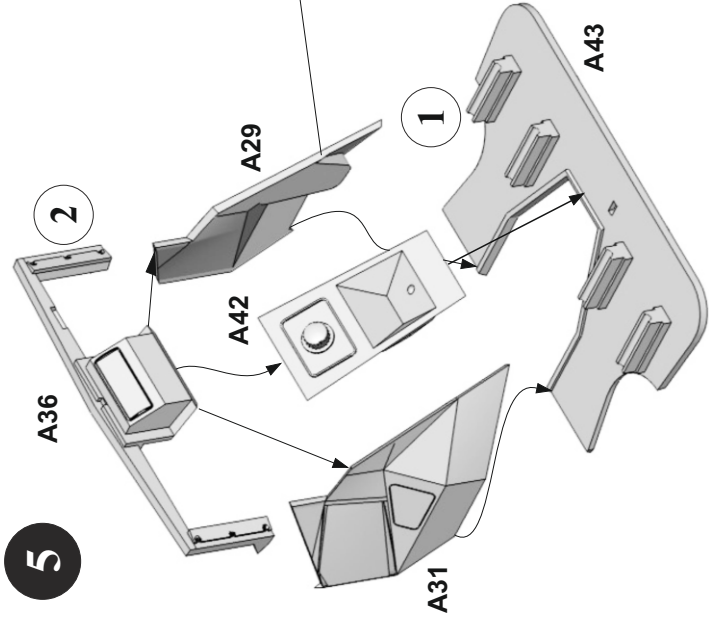

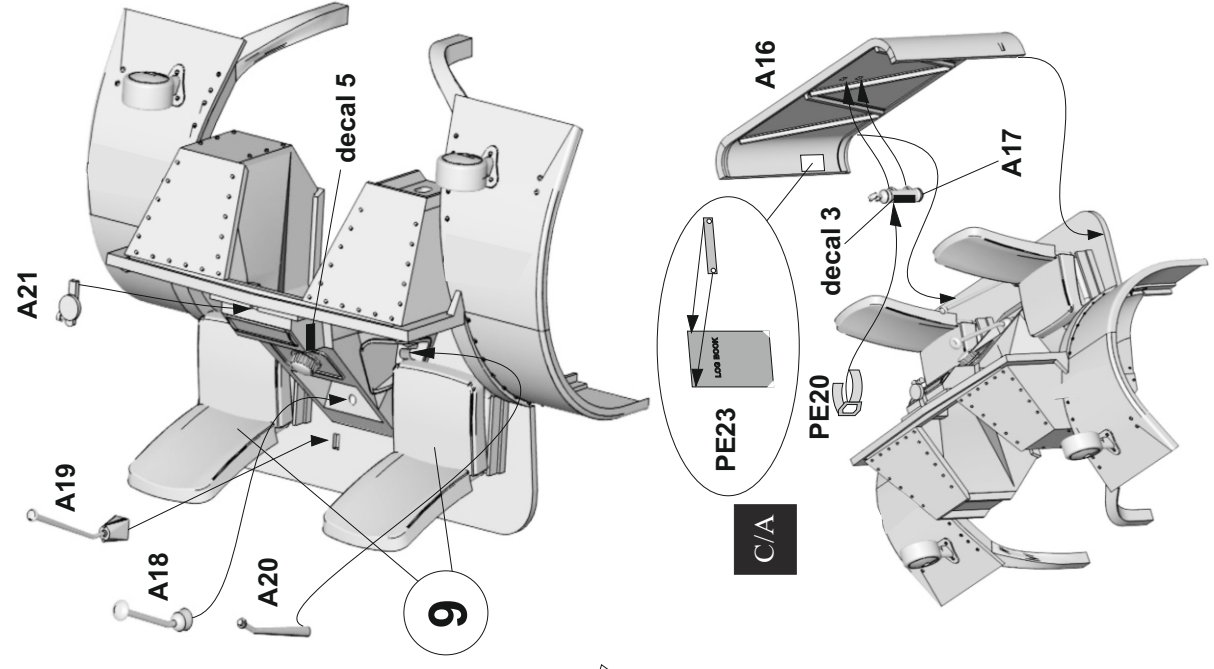
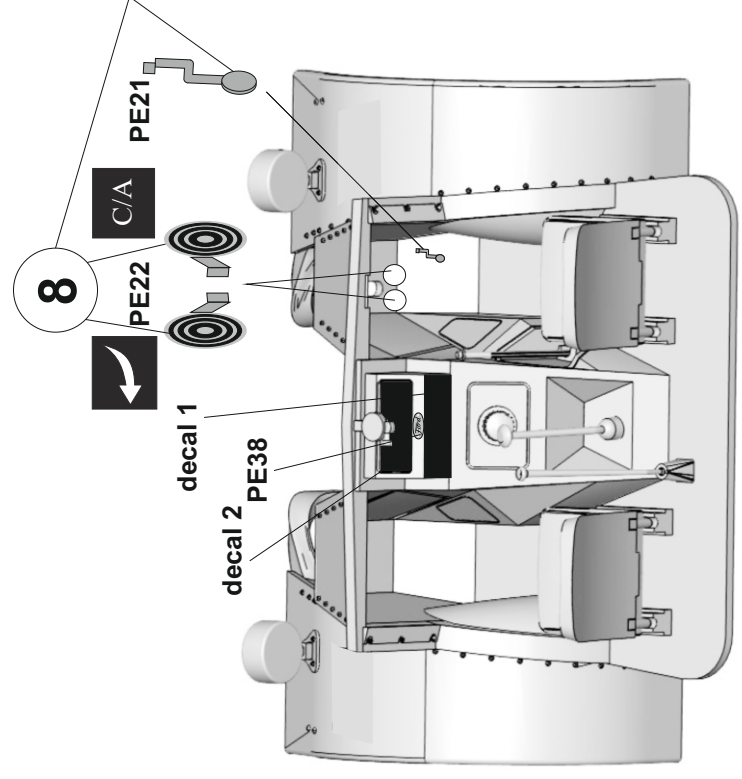
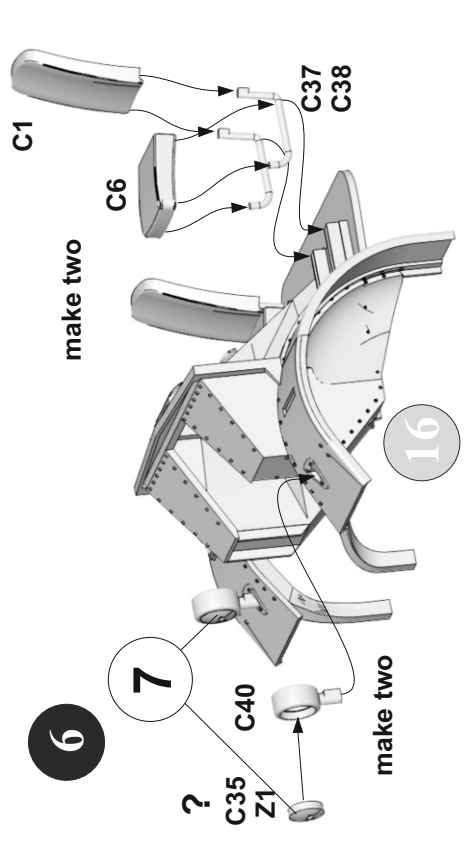

A17 paint brass color

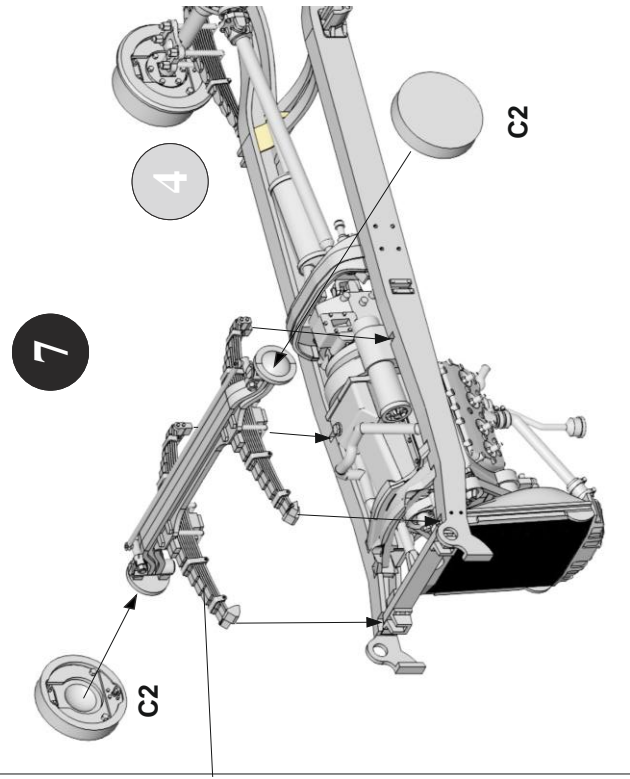
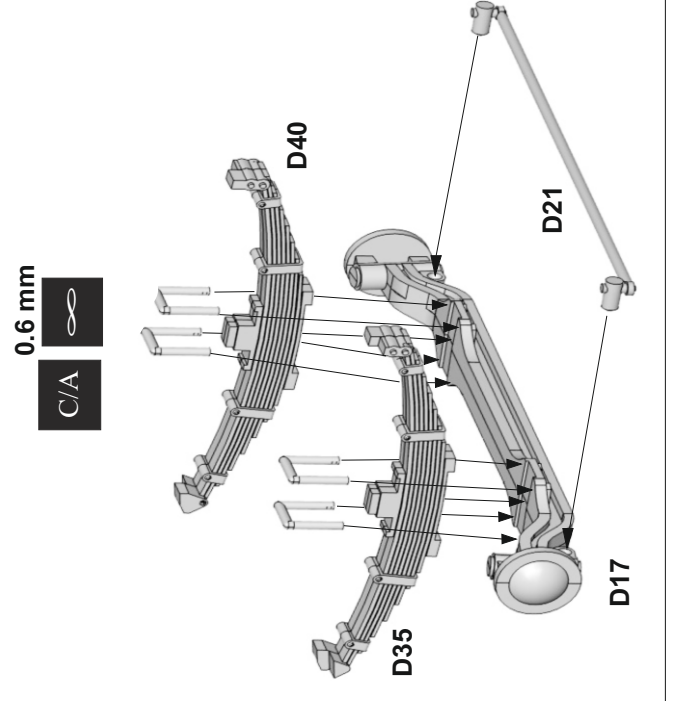

9

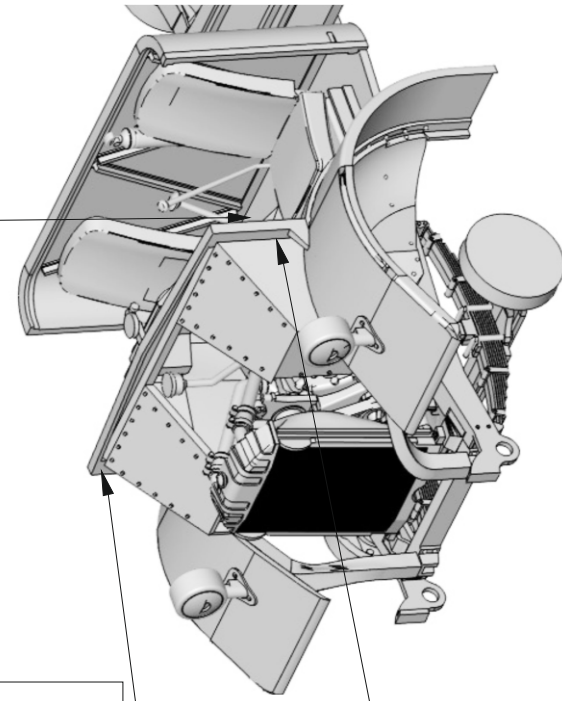
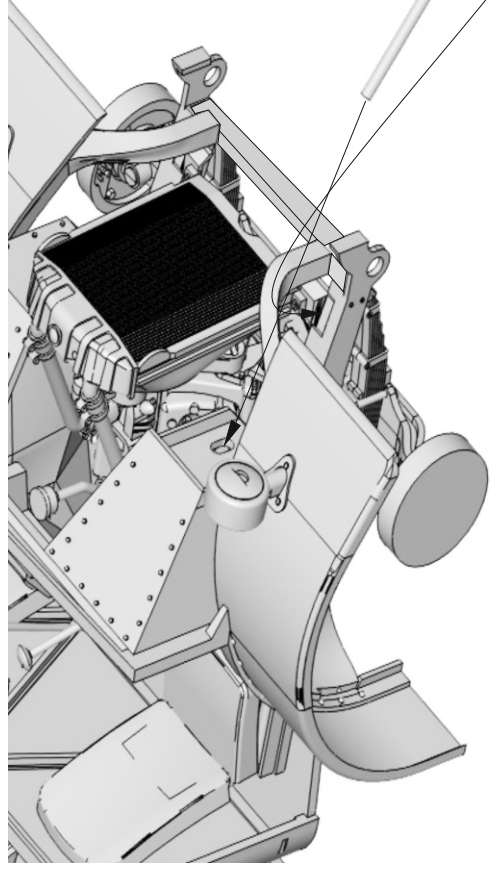
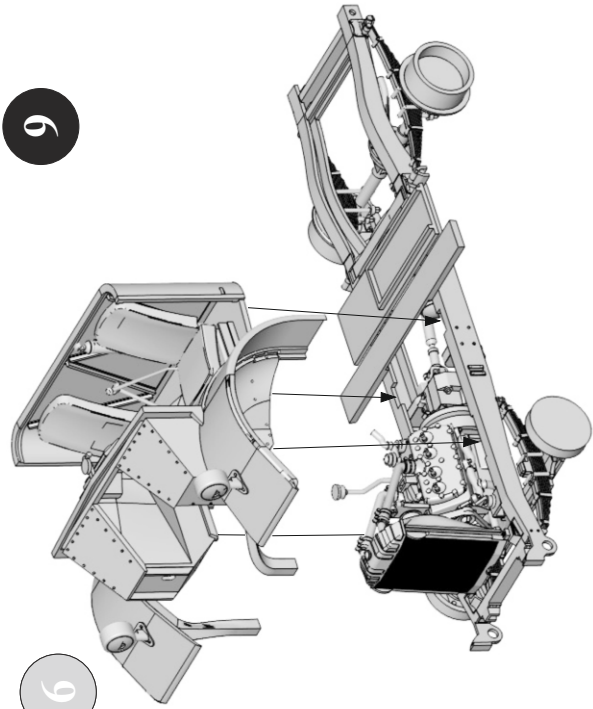

8

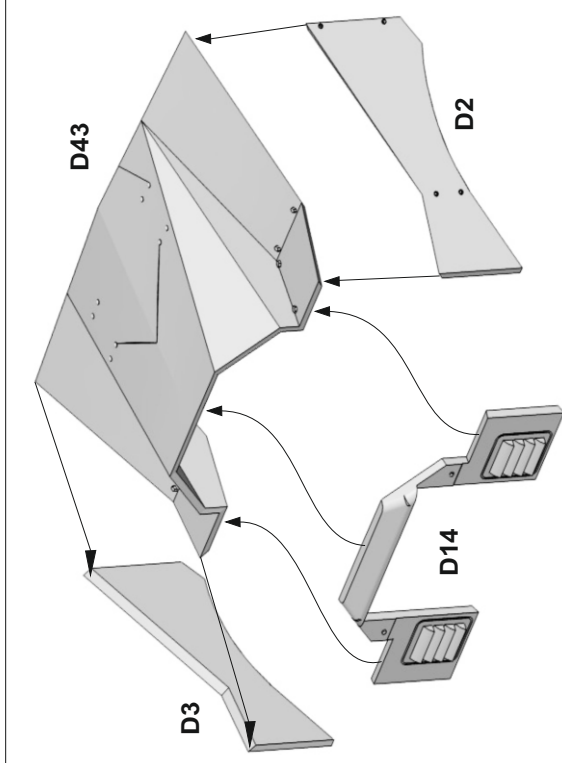
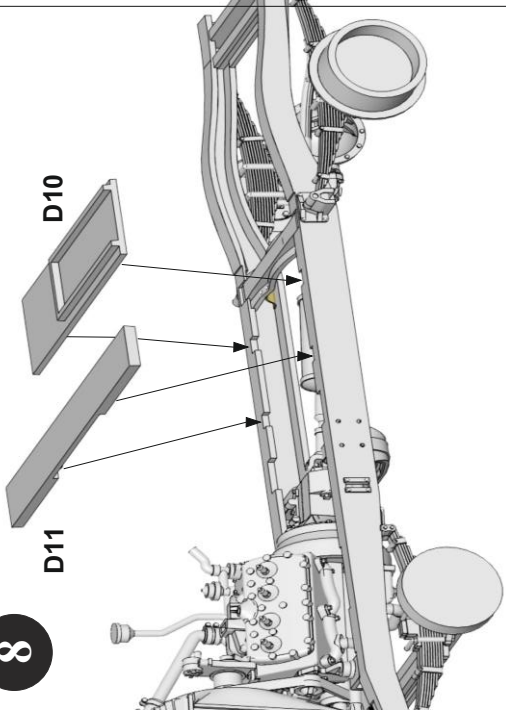

8



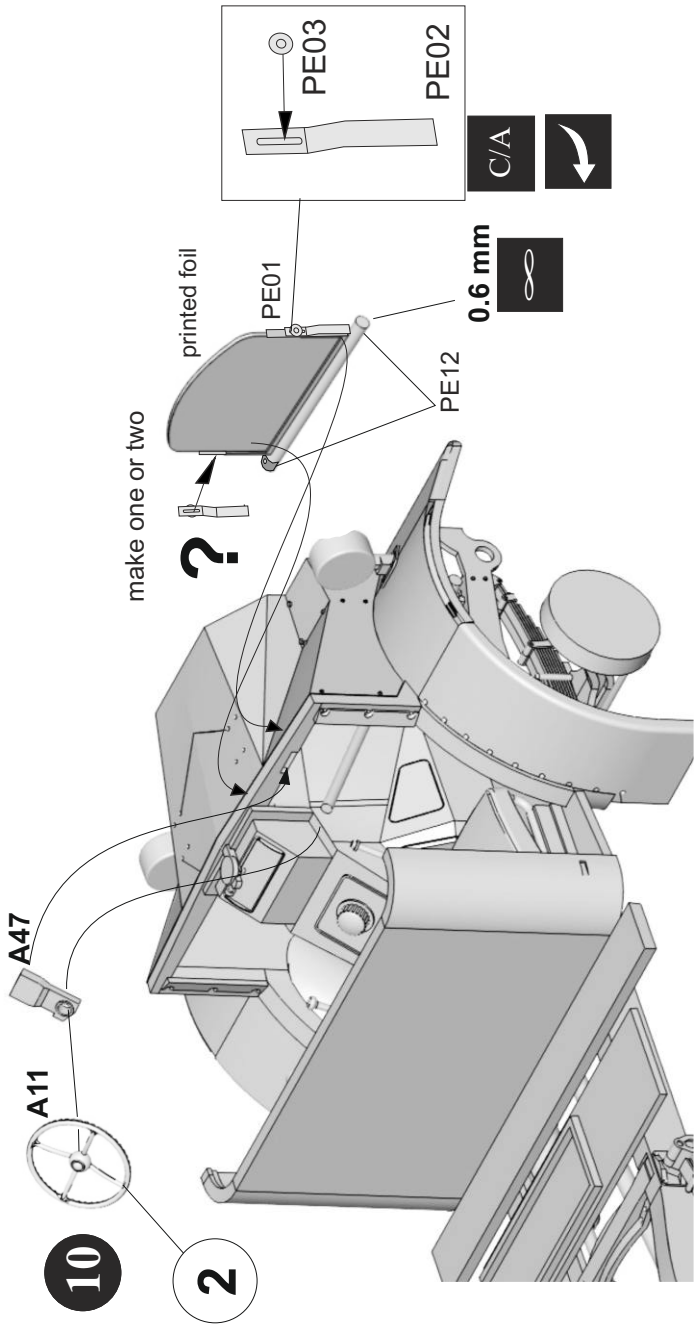

10

2

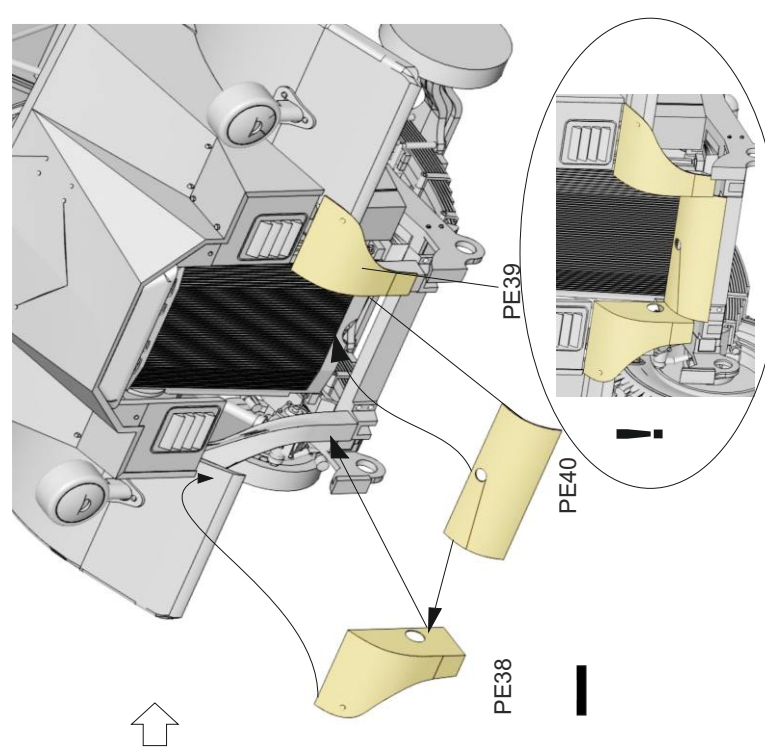
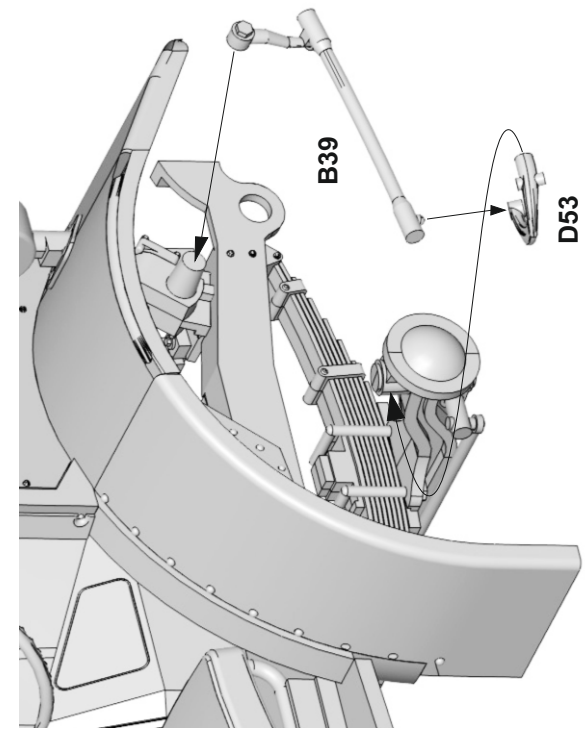
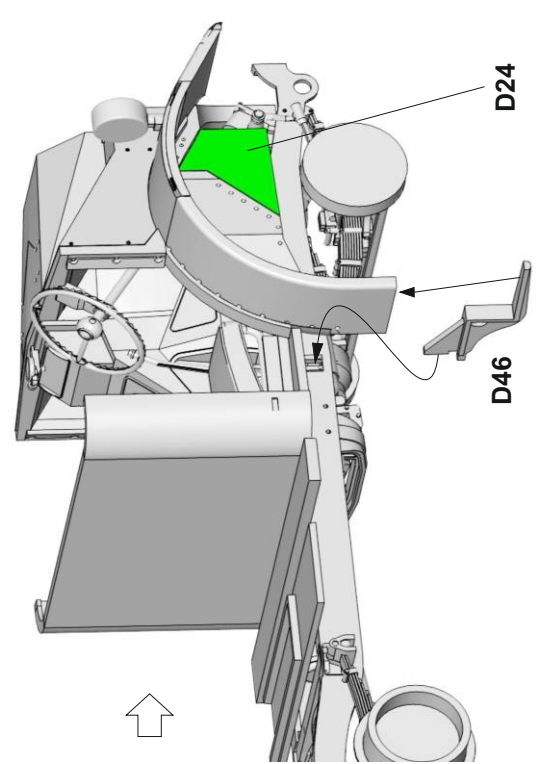
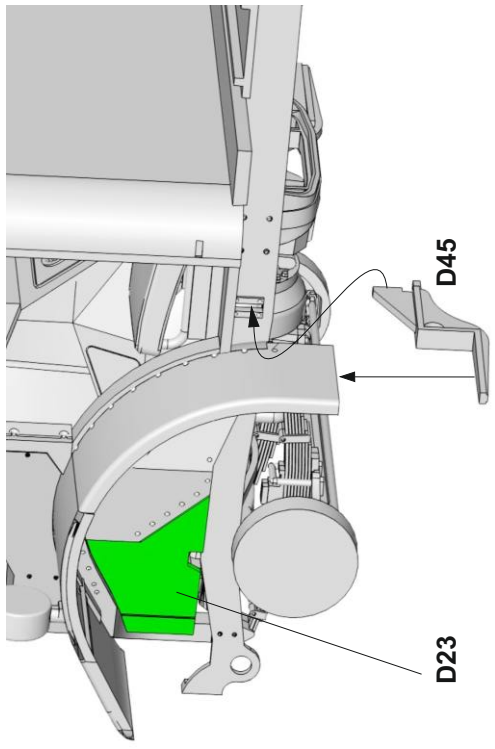

9

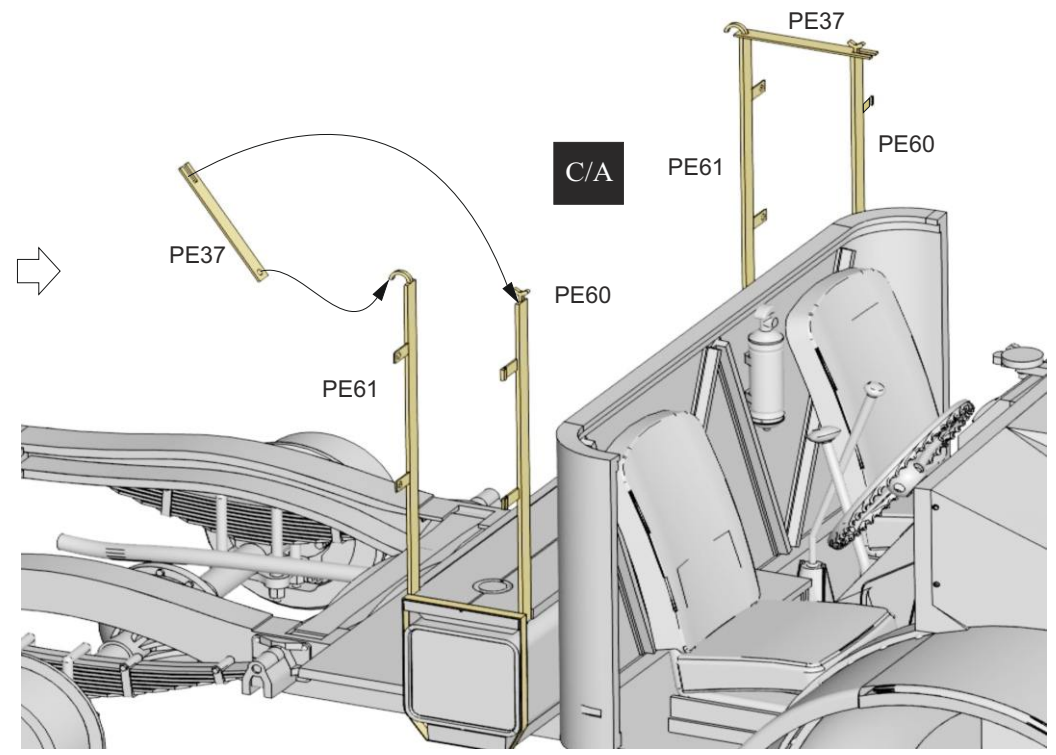
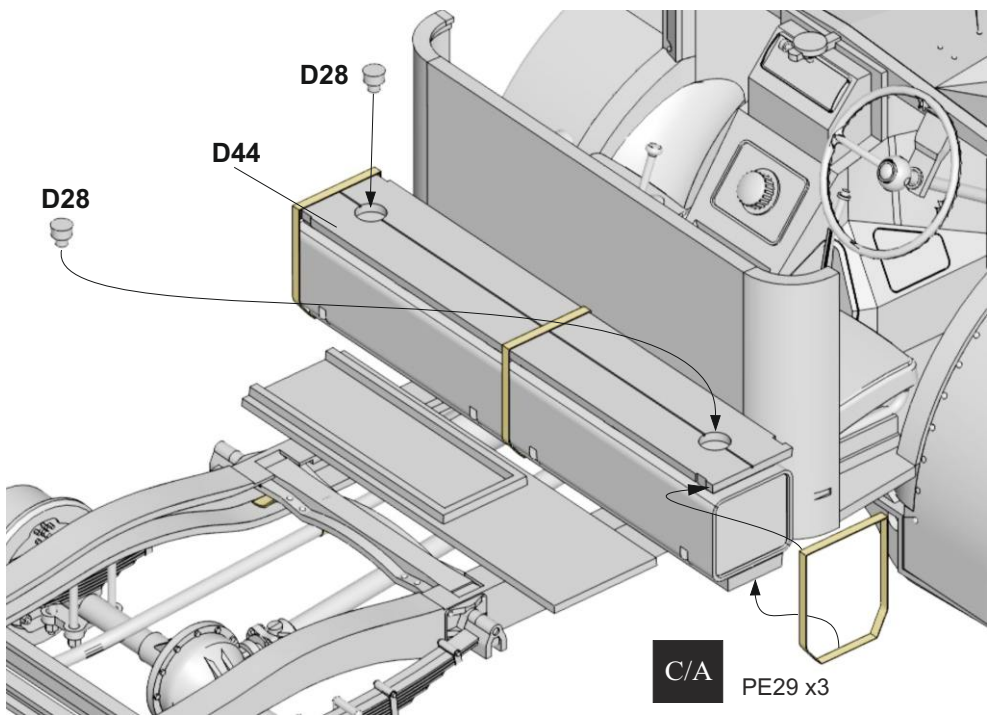
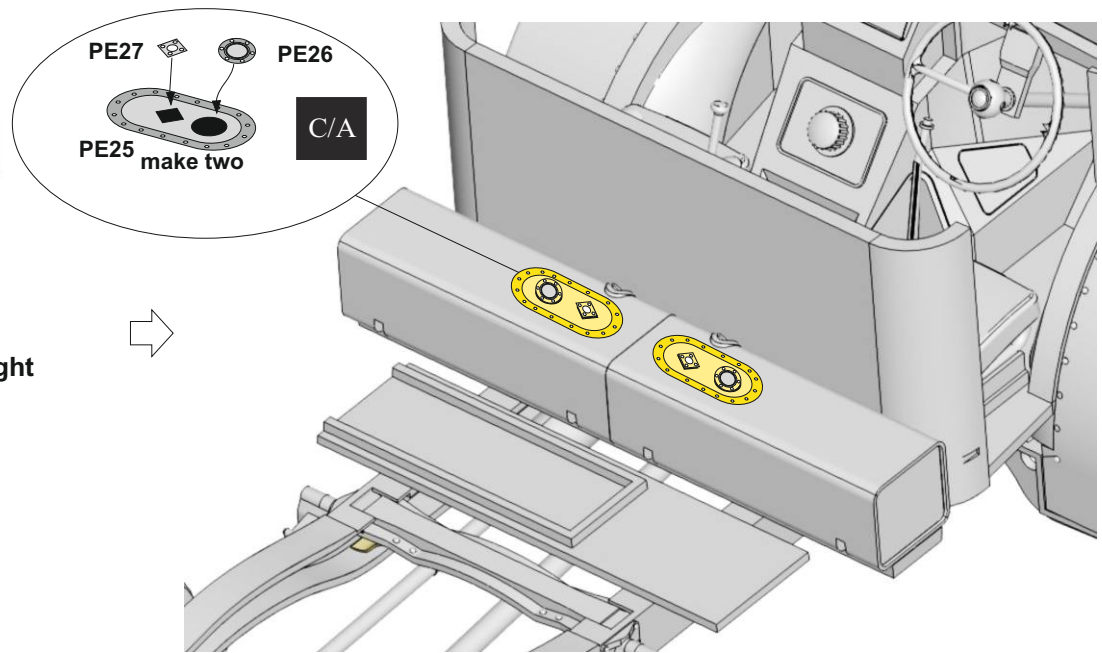
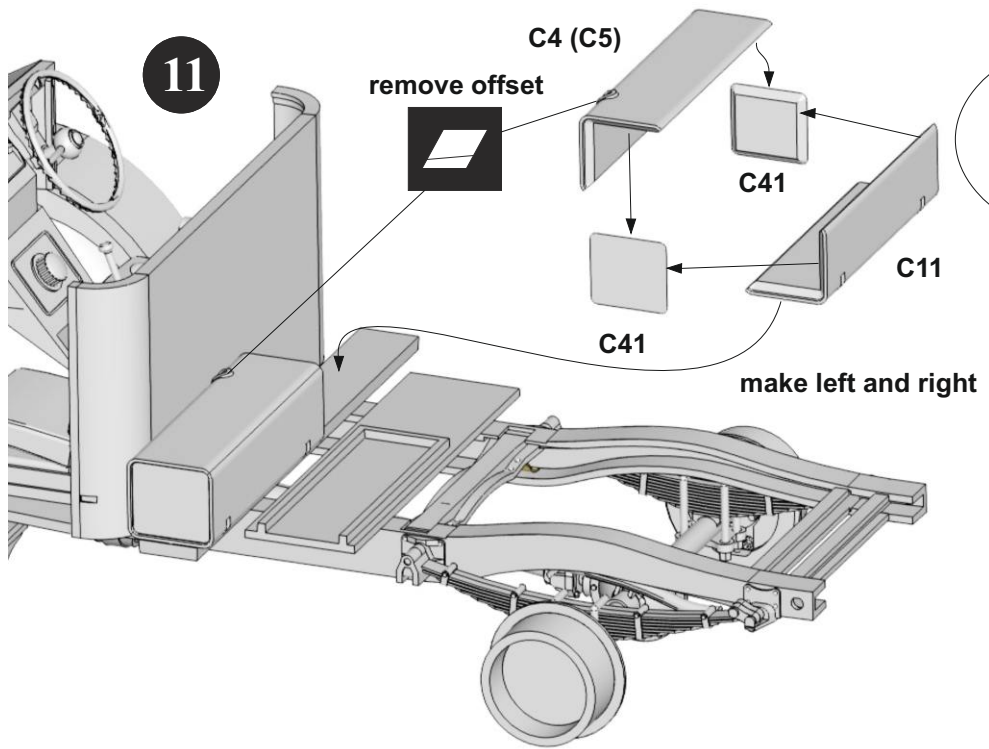

D16/D20

D25/D30

D31/D37

12

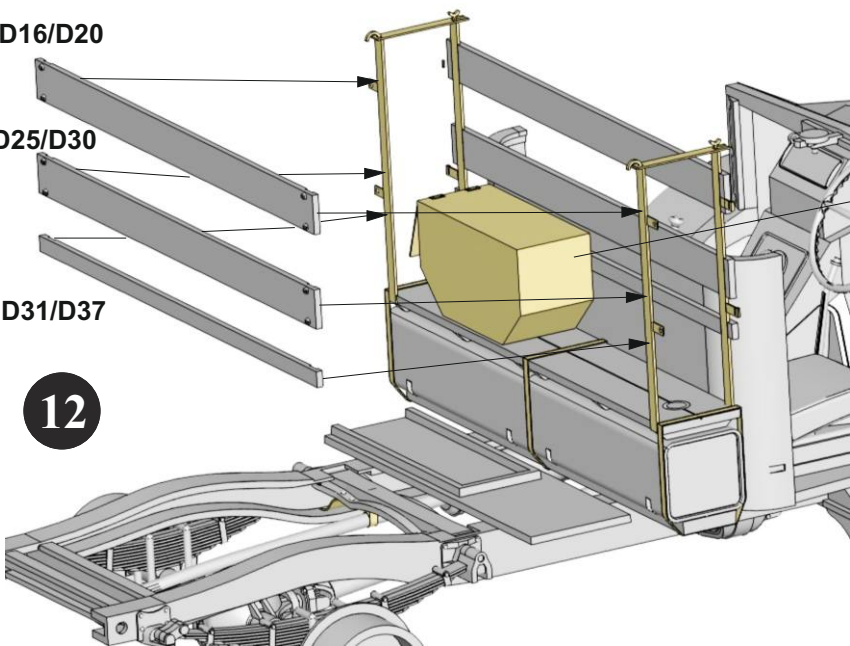

C/A

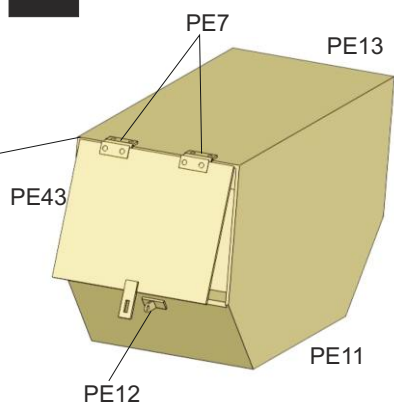

C/A

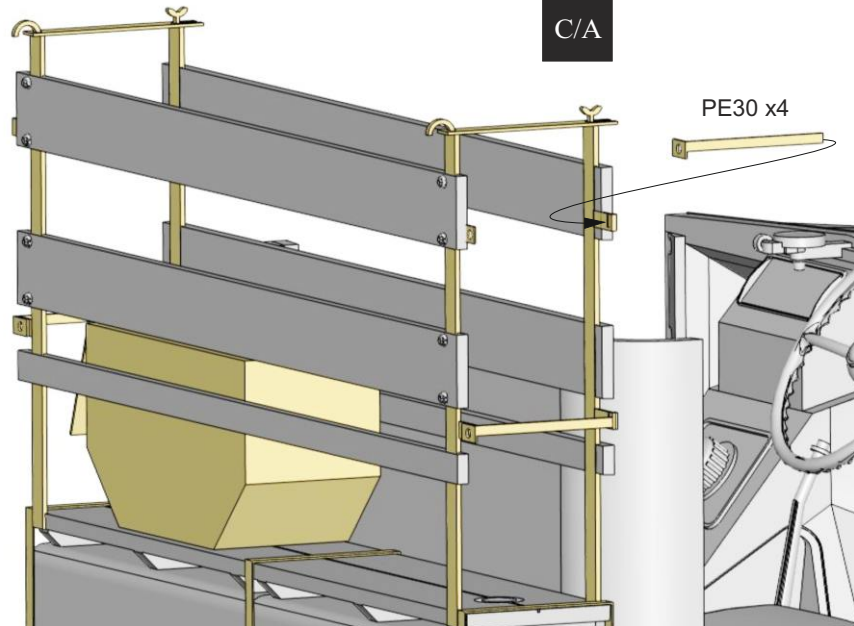

D9

D5

D6

D4

D15

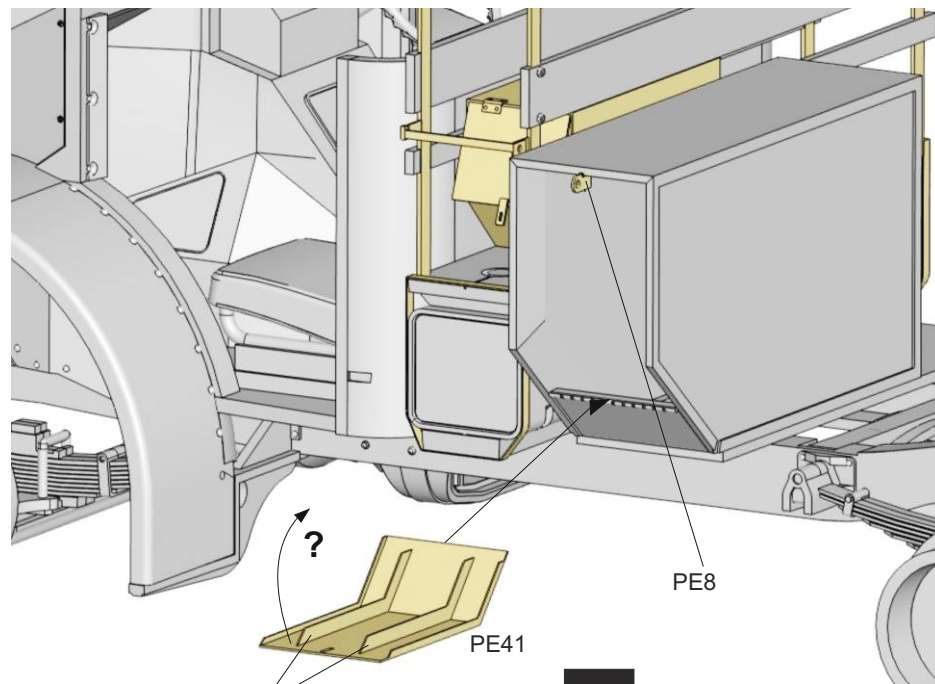
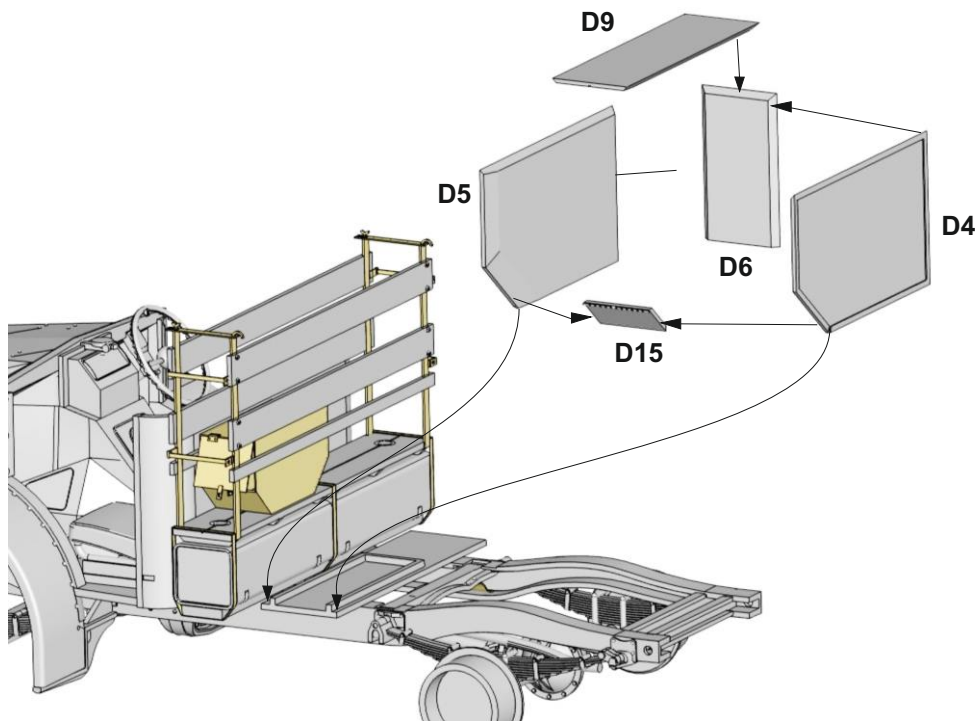

PE42

PE41

PE8

C/A

11

13

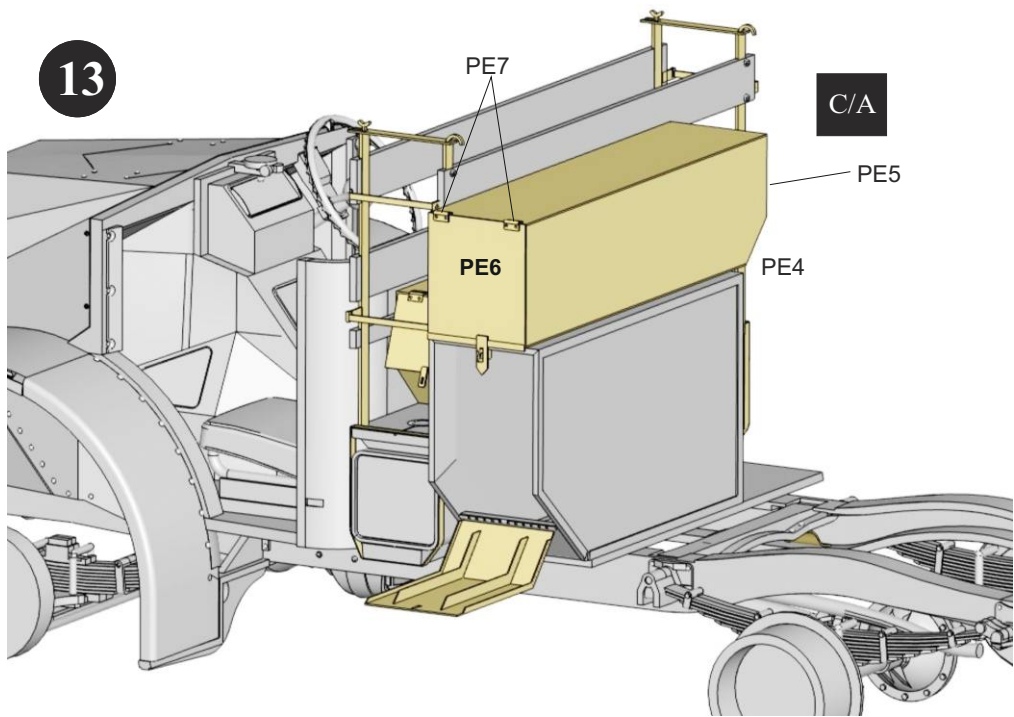

14

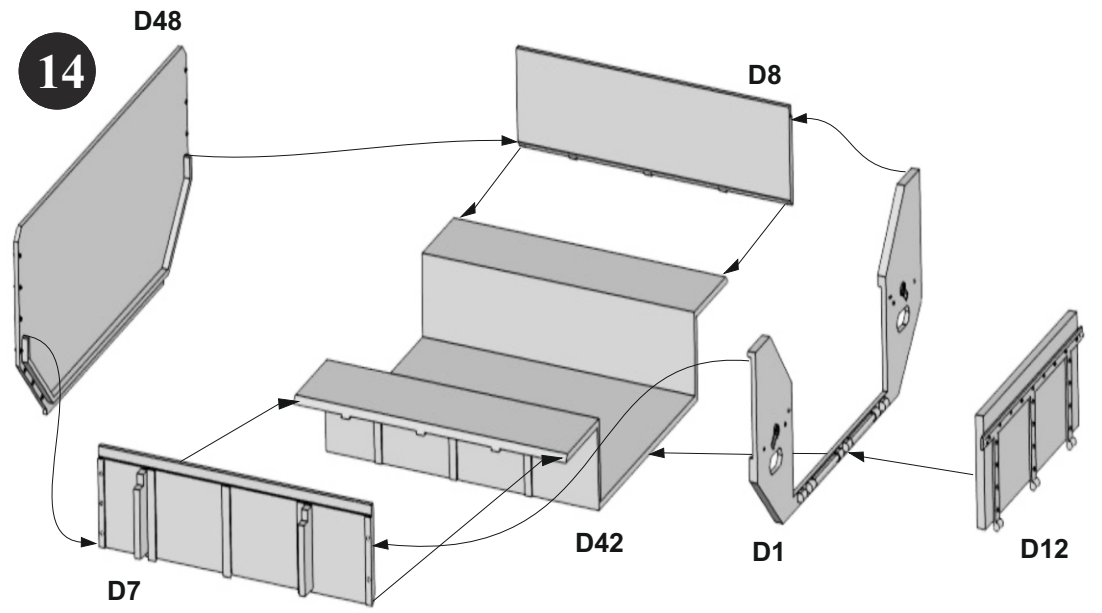

PE34



PE32

PE35

make two

PE33

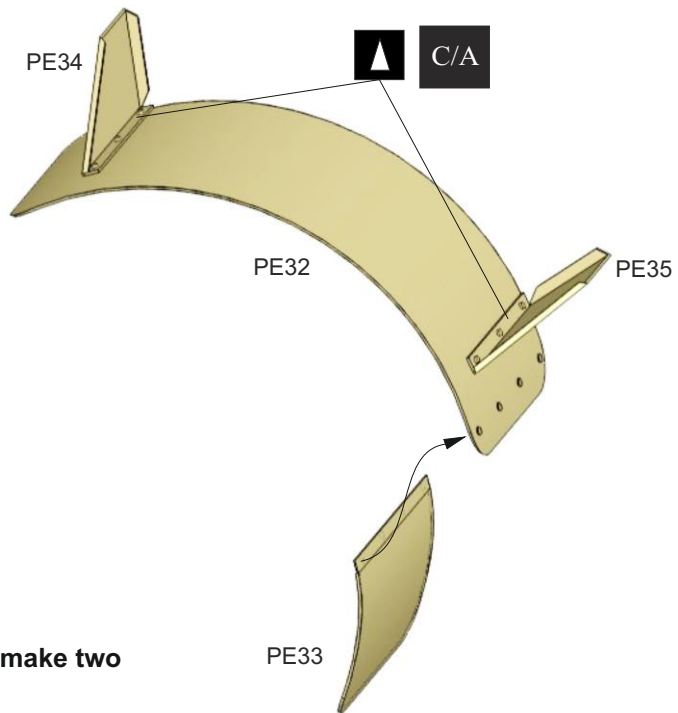

PE49



both sides

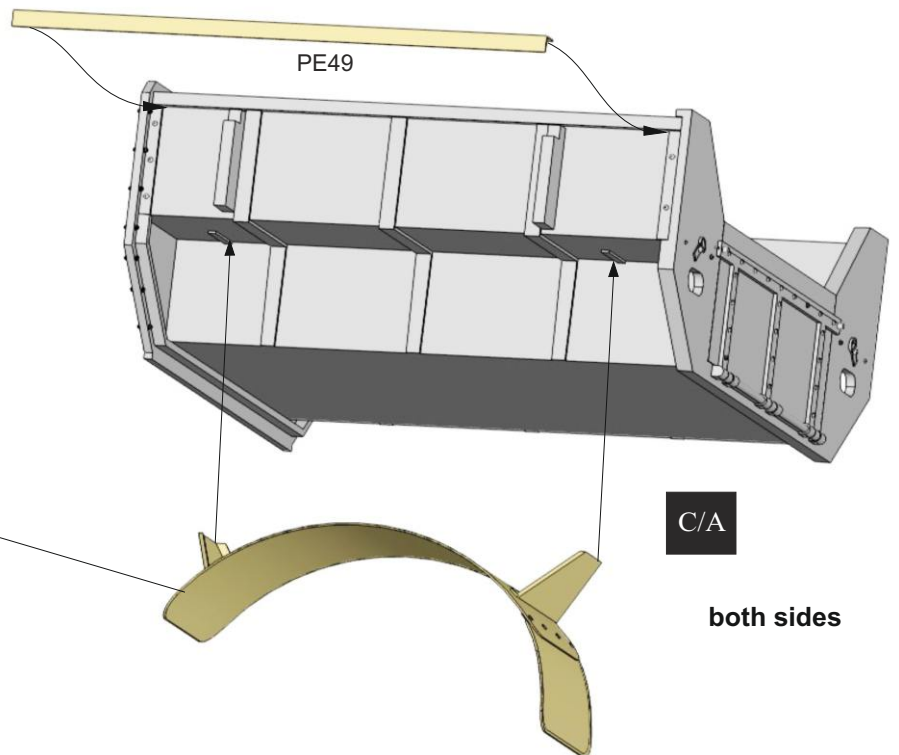

12

15

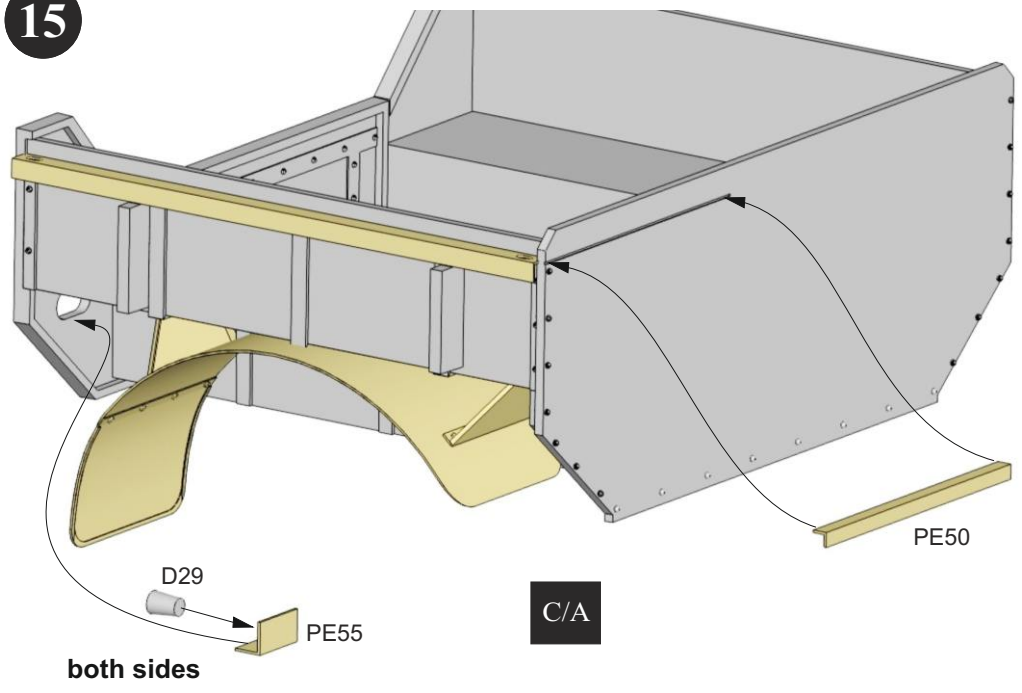

16

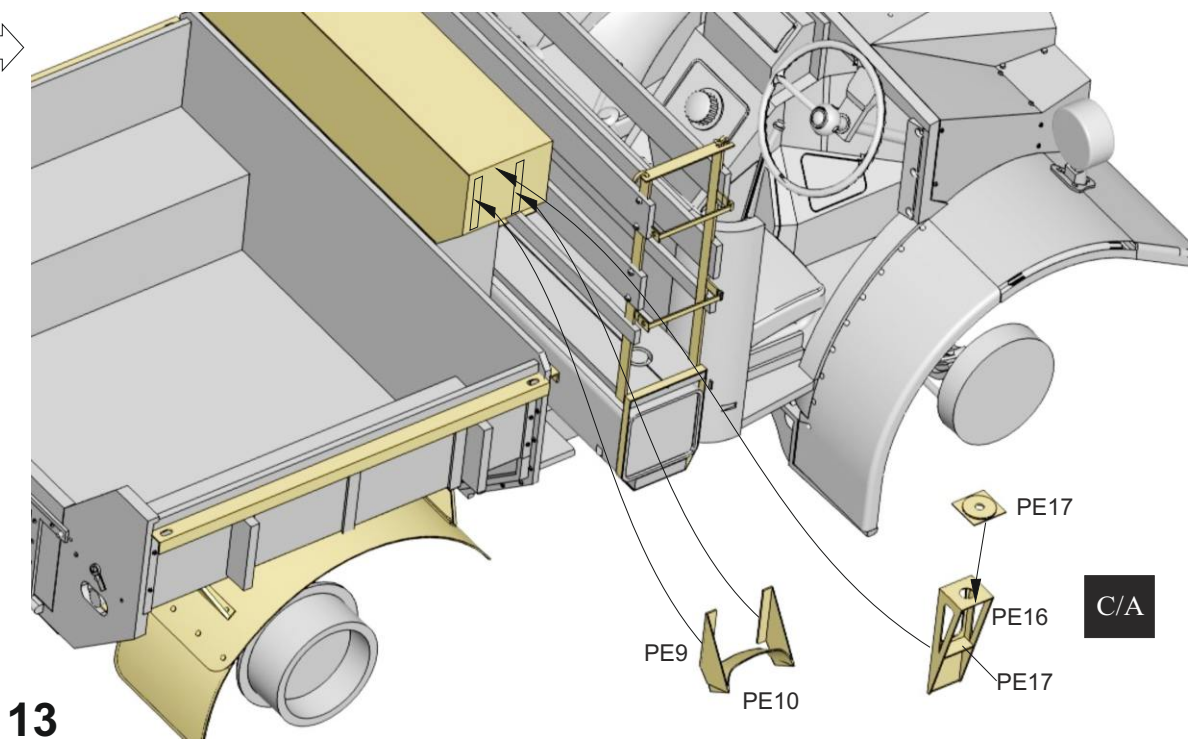
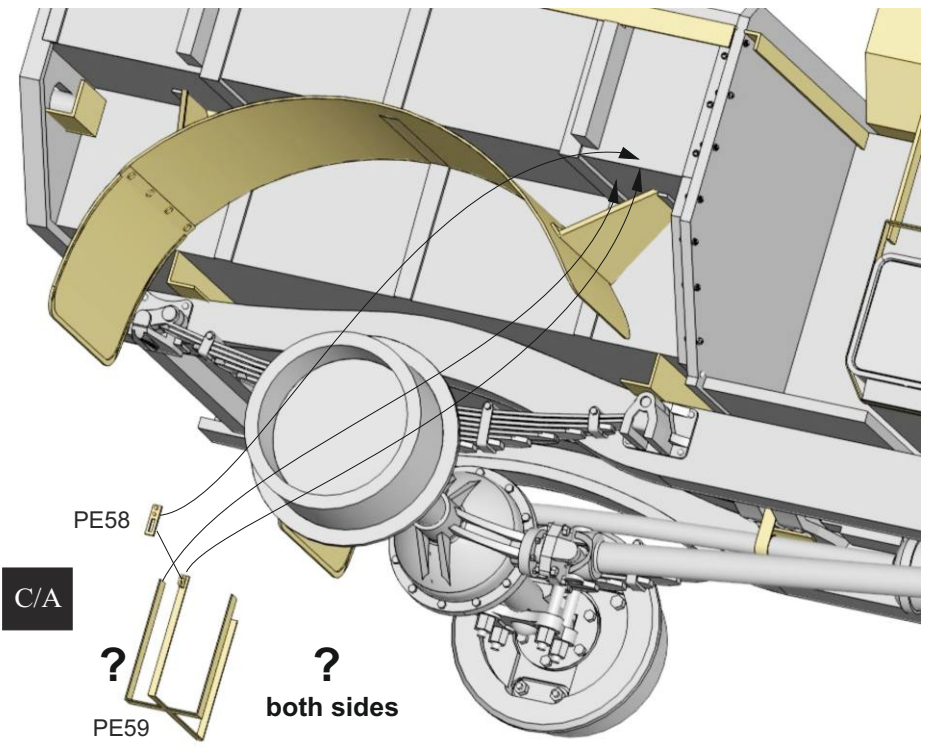
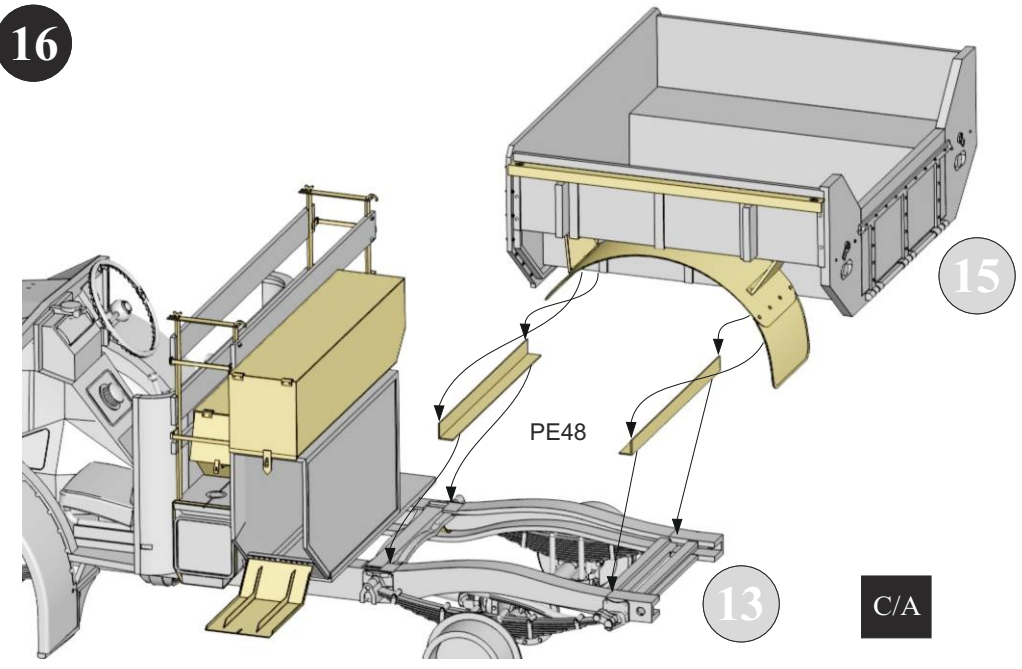

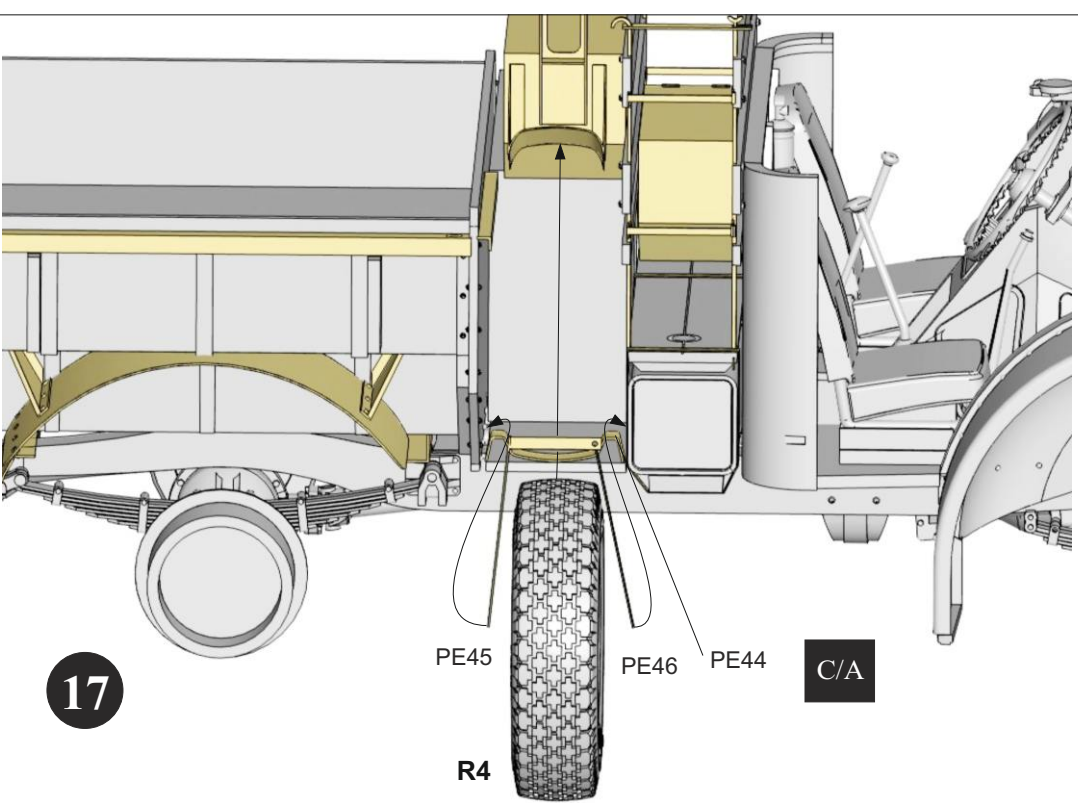

17

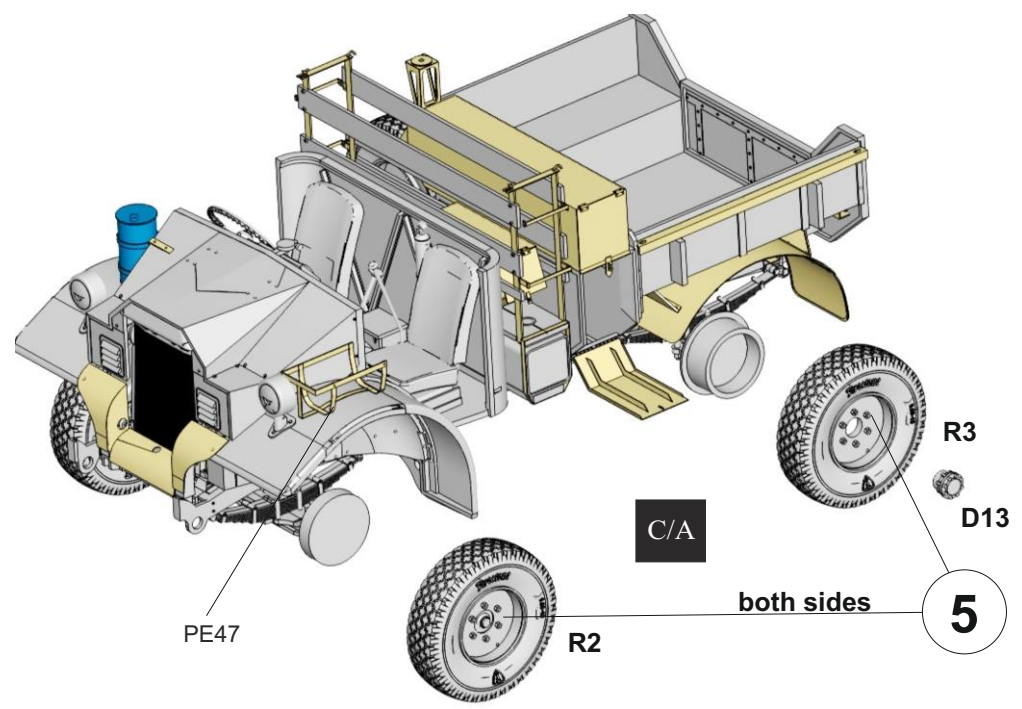
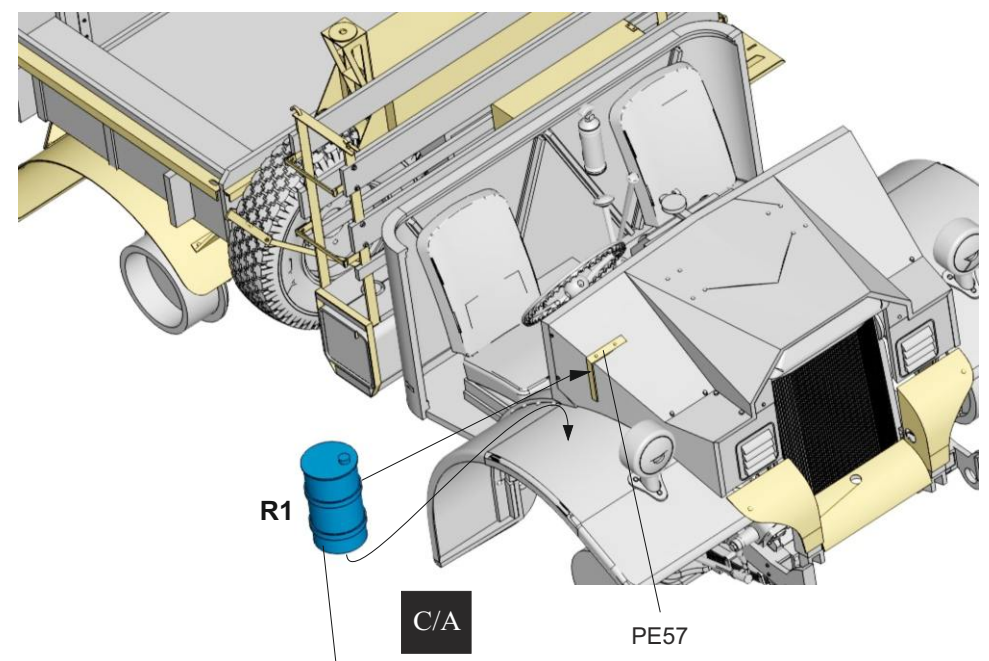

14

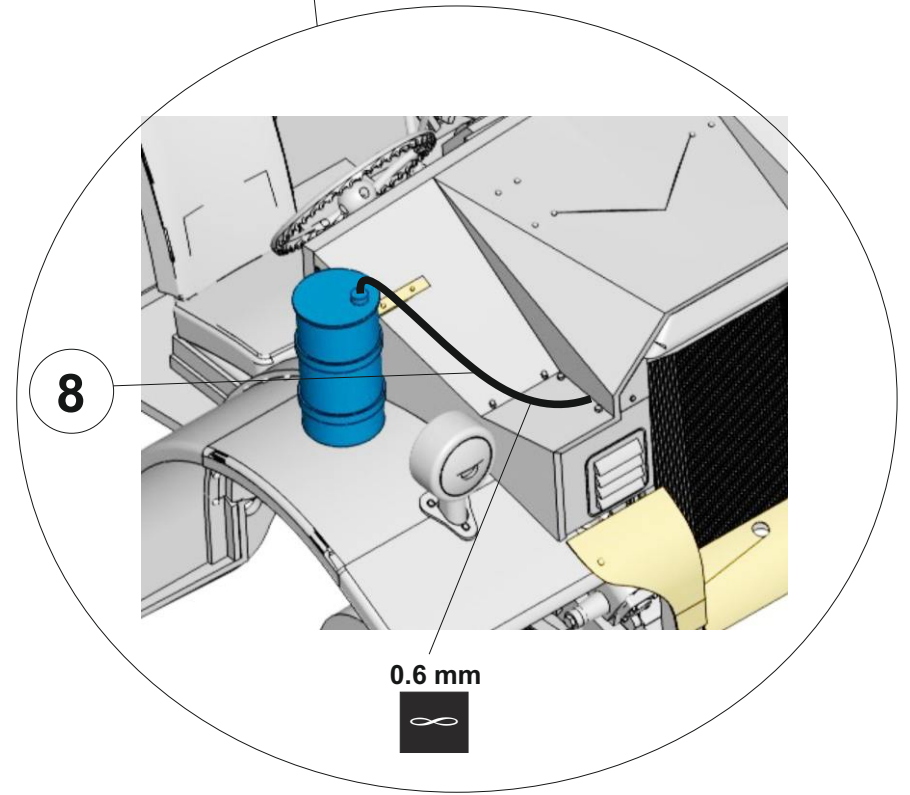

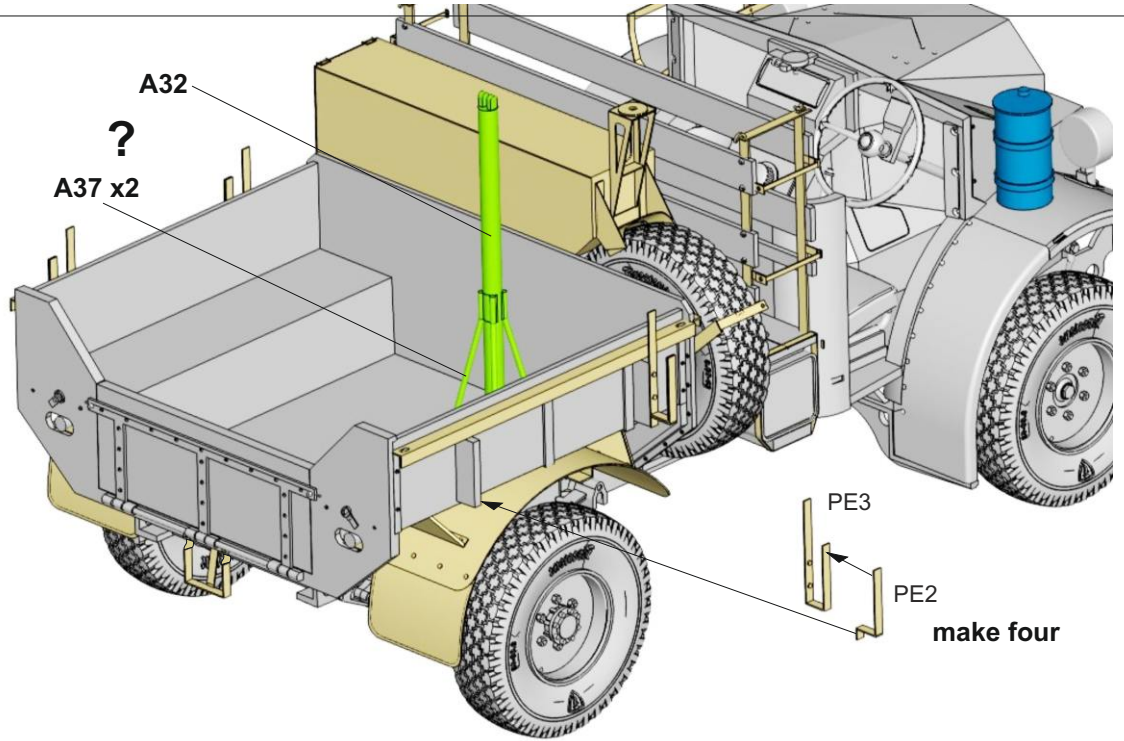
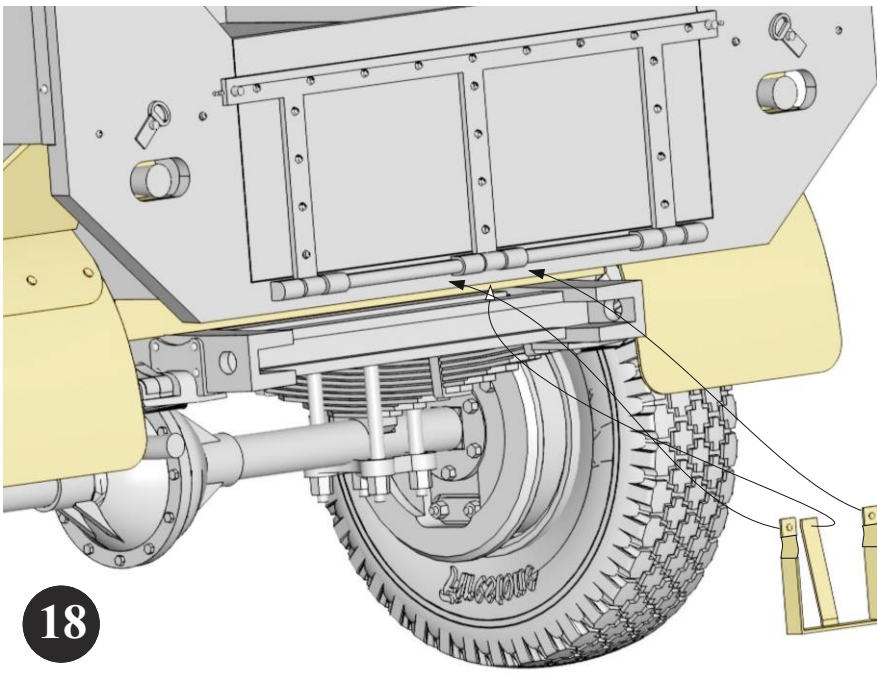

18

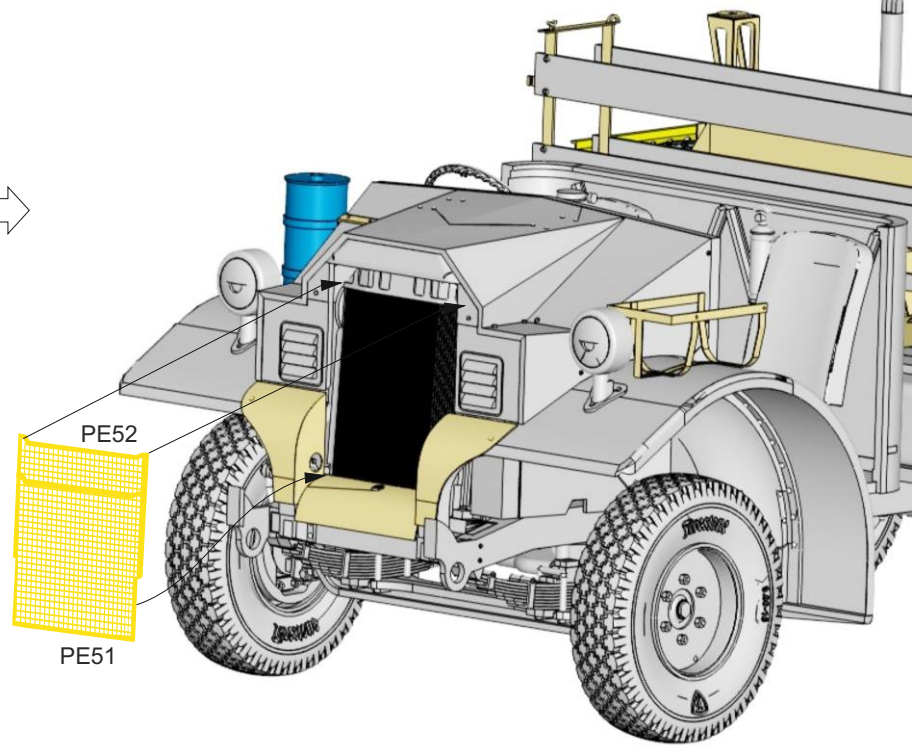
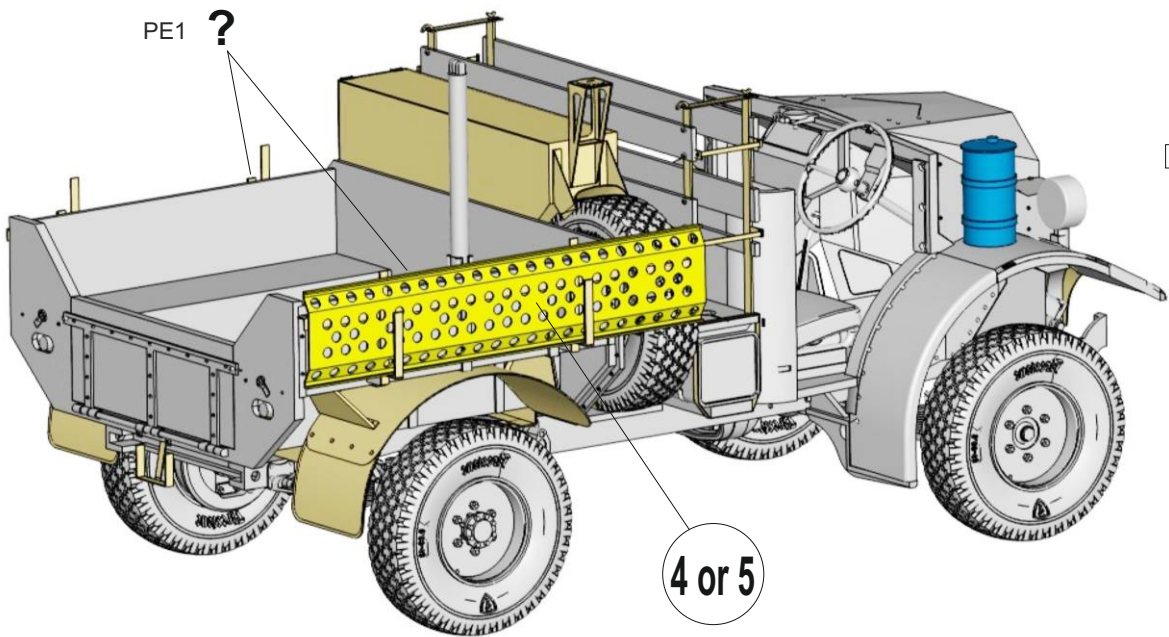

15

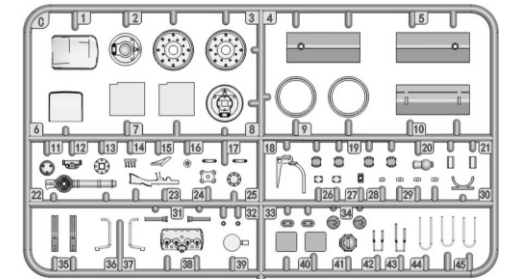
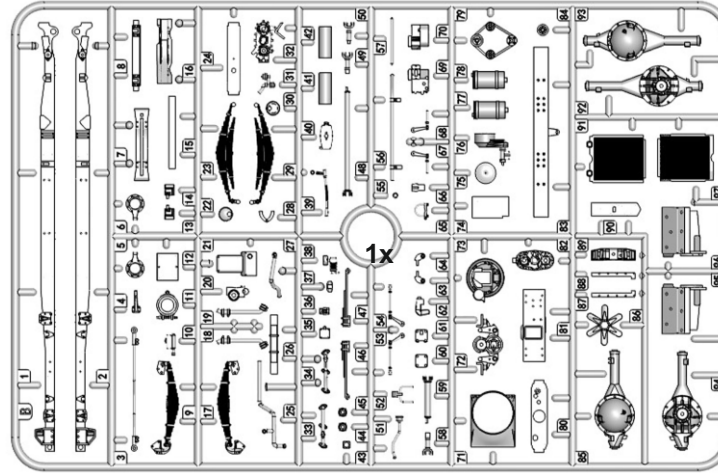
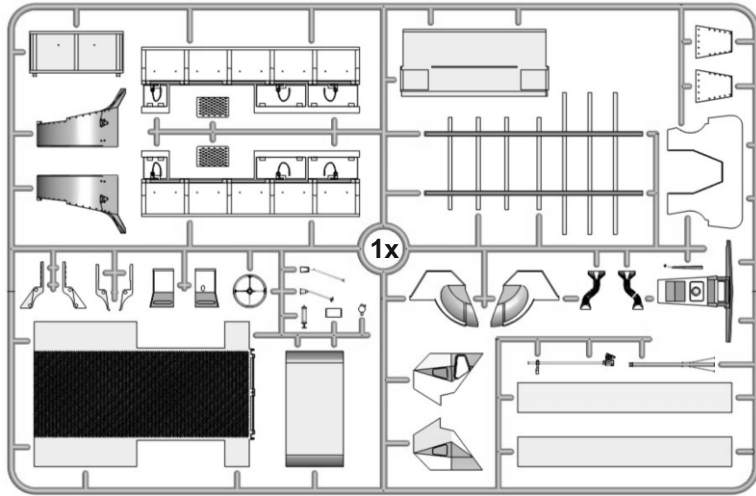

2x

2 clear parts  
 2 clear foil windscreens  
 4+1 resin wheels  
 3D printed parts

Bonus Edition extras:  
 2 resin figures  
 3D resin upgrade parts  
 and weapons

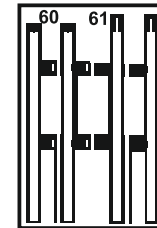
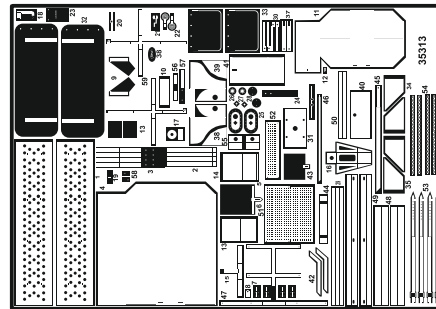
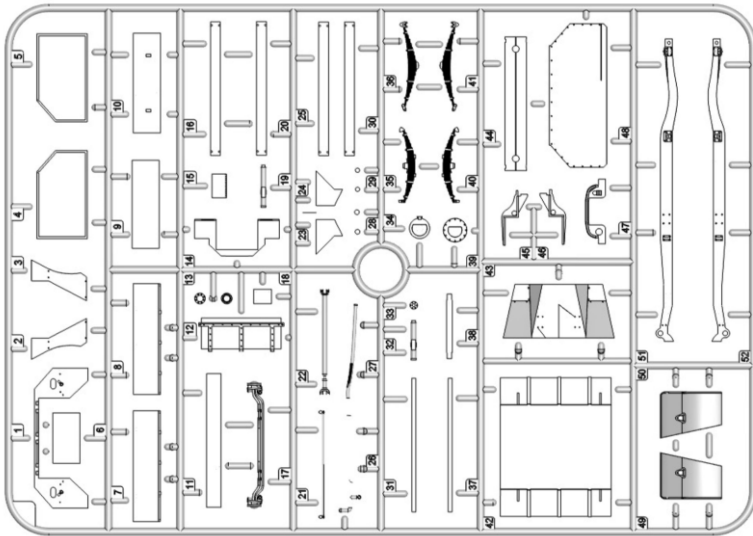

PDF instructions available at  
<https://www.thundermodel.com/Instructions--building-tips.html>  
 Facebook LRDG Build group:  
<https://www.facebook.com/groups/367361032605238>